

Only typed forms are accepted. Please send an electronic copy of the completed form.

If you need assistance completing the form, please contact Michael Houser, State Architectural Historian, at 360-586-3076 or Michael.houser@dahp.wa.gov.

Washington State HERITAGE BARN REGISTER 	Farm Name Koch Farm	Property Location Address: 12426 E. Bigelow Gulch Rd. City: Spokane Zip: 99217
	Historic Name	County Spokane
	Owners Name Dolores Koch / Jim Koch Phone: 509 926-5724 / 509 990-2544 Email: jimyk1@yahoo.com	Owner Address Address: 715 S. Jerstad Ln. City: Spokane Valley State: WA Zip: 99016 <i>SP 701</i>

BARN	ROOF SHAPE	ROOF COVERING	FLOOR PLAN	SIDING	FOUNDATION MATERIAL	PAINTING/ DECORATION	OTHER BARN FEATURES
CONDITION <input type="checkbox"/> Good <input checked="" type="checkbox"/> Fair <input type="checkbox"/> Poor <input type="checkbox"/> Altered <input type="checkbox"/> Ruins BARN BUILT DATE: c 1910	<input checked="" type="checkbox"/> Gable <input type="checkbox"/> Broken Gable <input type="checkbox"/> Gambrel <input type="checkbox"/> Hip <input type="checkbox"/> Gothic <input type="checkbox"/> Monitor <input type="checkbox"/> Round <input type="checkbox"/> Dutch <input type="checkbox"/> Conical <input type="checkbox"/> Other	<input type="checkbox"/> Asphalt <input type="checkbox"/> Metal <input checked="" type="checkbox"/> Wood <input type="checkbox"/> Other CURRENT USE <input checked="" type="checkbox"/> Ag <input type="checkbox"/> Vacant <input checked="" type="checkbox"/> Other storage	<input type="checkbox"/> Square <input checked="" type="checkbox"/> Rectangular <input type="checkbox"/> Round <input type="checkbox"/> Irregular <input type="checkbox"/> L- Shape <input type="checkbox"/> T- Shape Size (length & width): 60x30 Height (Feet): 30	<input type="checkbox"/> Metal <input type="checkbox"/> Wood – Horizontal <input checked="" type="checkbox"/> Wood – Board & Batten <input type="checkbox"/> Wood Vertical <input type="checkbox"/> Concrete <input type="checkbox"/> Brick <input type="checkbox"/> Stone <input type="checkbox"/> Asbestos <input type="checkbox"/> Other	<input type="checkbox"/> Concrete <input checked="" type="checkbox"/> Stone <input type="checkbox"/> Brick <input type="checkbox"/> Wood <input type="checkbox"/> None <input type="checkbox"/> Other FRAMING <input type="checkbox"/> Round Logs <input type="checkbox"/> Hand Hewn <input checked="" type="checkbox"/> Dimensional Lumber <input type="checkbox"/> Other	Painted? <input type="checkbox"/> No <input checked="" type="checkbox"/> Yes Color: red Names/Dates/ Decoration? <input checked="" type="checkbox"/> No <input type="checkbox"/> Yes Describe:	<input checked="" type="checkbox"/> Cupola <input type="checkbox"/> Dormer <input type="checkbox"/> Hay Hood <input type="checkbox"/> Ventilator <input type="checkbox"/> Weather Vane <input type="checkbox"/> Lightning Rod <input type="checkbox"/> Silo <input type="checkbox"/> Milking Shed <input type="checkbox"/> Other

*** PROPERTY HISTORY:** (Expand on the history of the barn/property such as use, original owner, builder, architect, family stories and memories, etc.. add additional pages if necessary)

Farm/Barnearly on was for cattle, horse, chickens, pigs, crops and hay. Farm has original bunk house and brick shop (belived to have been built by C.C.C).

Please provide current photos of nominated property (interior and exterior (all four sides)) and a map indicating the location of property in relationship to major roads. Digital images are preferred (please provide disc) or print on photographic paper.

Only typed forms are accepted. Please send an electronic copy of the completed form.

If you need assistance completing the form, please contact Michael Houser, State Architectural Historian, at 360-586-3076 or Michael.houser@dahp.wa.gov.

OTHER FARMSTEAD BUILDINGS

If building does not exist, please check N/A box

Provide additional photos of secondary buildings/structures regardless of age.

	ROOF SHAPE (Gable, Hip, etc.)	ROOF COVERING	FLOOR PLAN (Square, L-Shape, Rectangular, etc.)	SIDING	FOUNDATION MATERIAL	OTHER FEATURES: (Style, Color, Trim, etc..)	BUILT DATE
DWELLING <input checked="" type="checkbox"/> Good <input type="checkbox"/> Fair <input type="checkbox"/> Poor <input type="checkbox"/> Altered <input type="checkbox"/> Ruins <input type="checkbox"/> N/A	hip & gable or cross gable	composit	square	wood and vinyl	stone	white	1890's
OUTHOUSE <input type="checkbox"/> Good <input checked="" type="checkbox"/> Fair <input type="checkbox"/> Poor <input type="checkbox"/> Altered <input type="checkbox"/> Ruins <input type="checkbox"/> N/A	gable	cedar shake	square	wood	stone	red	1890's
CHICKEN COOP <input type="checkbox"/> Good <input type="checkbox"/> Fair <input type="checkbox"/> Poor <input type="checkbox"/> Altered <input type="checkbox"/> Ruins <input checked="" type="checkbox"/> N/A							
MACHINE SHED <input type="checkbox"/> Good <input type="checkbox"/> Fair <input type="checkbox"/> Poor <input type="checkbox"/> Altered <input type="checkbox"/> Ruins <input checked="" type="checkbox"/> N/A							
MILK HOUSE <input type="checkbox"/> Good <input type="checkbox"/> Fair <input type="checkbox"/> Poor <input type="checkbox"/> Altered <input type="checkbox"/> Ruins <input checked="" type="checkbox"/> N/A							
SILO <input type="checkbox"/> Good <input checked="" type="checkbox"/> Fair <input type="checkbox"/> Poor <input type="checkbox"/> Altered <input type="checkbox"/> Ruins <input type="checkbox"/> N/A	cone	metal	round	metal	concrete		1974
OTHER: shop <input type="checkbox"/> Good <input type="checkbox"/> Fair <input type="checkbox"/> Poor <input type="checkbox"/> Altered <input type="checkbox"/> Ruins <input type="checkbox"/> N/A	gable	metal	rectangle	brick	brick/concrete		1940's
OTHER: bunk house <input type="checkbox"/> Good <input type="checkbox"/> Fair <input type="checkbox"/> Poor <input type="checkbox"/> Altered <input type="checkbox"/> Ruins <input checked="" type="checkbox"/> N/A	gable	cedar shake	rectangle	metal	wood		early 1900's

Please provide a sketch of the farmstead layout indicating the location of other buildings in relation to the barn. Include an arrow pointing north for directional purposes.

Return form and additional documentation to: **DAHP** 1063 S. Capitol Way, Suite 106 Olympia, WA 98504



Koch Farm
 12426 E. Bigelow Gulch Rd.
 Spokane, WA 99217

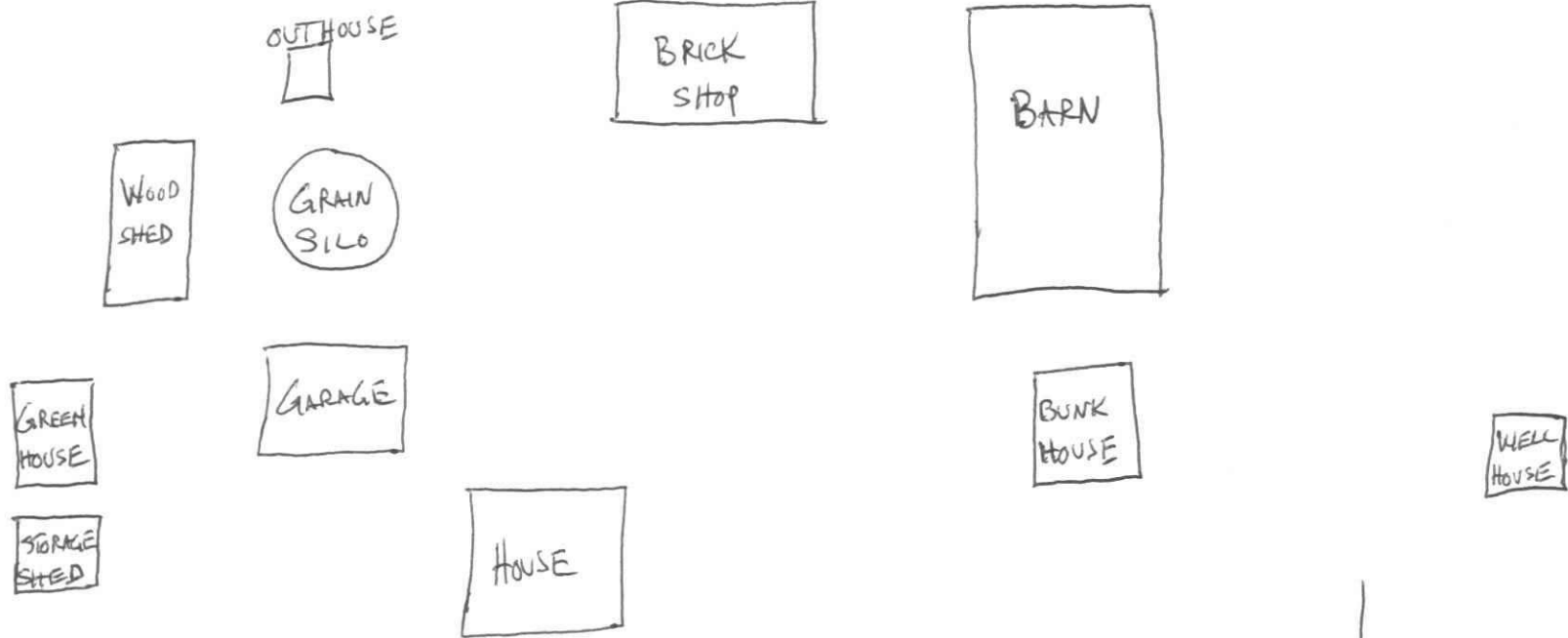

BIGELOW Gulch Rd.



