

SP 561

Please note that sections with an "\*" must be completed or your application can not be processed.  
 If you need assistance completing the form, please contact Michael Houser, State Architectural Historian, at 360-586-3076 or Michael.houser@dahp.wa.gov.

Washington State <b>HERITAGE BARN REGISTER</b> 	<b>Farm Name</b> McGourin Farms, Inc.	<b>* Property Location</b> Address: 28101 S. Philleo Lake Road City: Spangle Zip: 99031
	<b>Historic Name</b> Philleo Barn	<b>County</b> Spokane
	<b>* Owners Name</b> Pat & Debbie McGourin  Phone: 509-245-3401 Email: magooroo@dishmail.net	<b>* Owner Address</b> Address: Same as above City: State: WA Zip:

BARN	ROOF SHAPE	ROOF COVERING	FLOOR PLAN	SIDING	FOUNDATION MATERIAL	PAINTING/ DECORATION	OTHER BARN FEATURES
<b>CONDITION</b> <input type="checkbox"/> Good <input type="checkbox"/> Fair <input checked="" type="checkbox"/> Poor <input type="checkbox"/> Altered <input type="checkbox"/> Ruins  <b>* BARN BUILT DATE:</b> c.1920	<input type="checkbox"/> Gable <input checked="" type="checkbox"/> Gambrel <input type="checkbox"/> Gothic <input type="checkbox"/> Monitor <input type="checkbox"/> Round <input type="checkbox"/> Shed <input type="checkbox"/> Conical <input type="checkbox"/> Other	<input type="checkbox"/> Asphalt <input checked="" type="checkbox"/> Metal <input type="checkbox"/> Wood <input type="checkbox"/> Other  <b>* CURRENT USE</b> <input checked="" type="checkbox"/> Ag <input type="checkbox"/> Vacant <input type="checkbox"/> Other	<input type="checkbox"/> Square <input checked="" type="checkbox"/> Rectangular <input type="checkbox"/> Round <input type="checkbox"/> Irregular <input type="checkbox"/> L- Shape <input type="checkbox"/> T- Shape Size: 40' x 70'  Height: 45' to peak, 20' at eaves	<input type="checkbox"/> Metal <input checked="" type="checkbox"/> Wood – Horizontal <input type="checkbox"/> Wood – Board & Batten <input type="checkbox"/> Wood Vertical <input type="checkbox"/> Concrete <input type="checkbox"/> Brick <input type="checkbox"/> Stone <input type="checkbox"/> Asbestos <input type="checkbox"/> Other	<input checked="" type="checkbox"/> Concrete <input type="checkbox"/> Stone <input type="checkbox"/> Brick <input type="checkbox"/> Wood <input type="checkbox"/> None <input type="checkbox"/> Other	Painted? <input type="checkbox"/> No <input checked="" type="checkbox"/> Yes Color: Red  Names/Dates/ Decoration? <input checked="" type="checkbox"/> No <input type="checkbox"/> Yes Describe:	<input checked="" type="checkbox"/> Cupola <input type="checkbox"/> Dormer <input type="checkbox"/> Hay Hood <input checked="" type="checkbox"/> Ventilator <input type="checkbox"/> Weather Vane <input type="checkbox"/> Lightning Rod <input type="checkbox"/> Silo <input type="checkbox"/> Milking Shed <input type="checkbox"/> Other

**\* PROPERTY HISTORY: (Expand on the history of the barn/property such as use, builder, architect, family stories and memories, etc.. add additional pages if necessary)**

The nominated barn was built as a replacement barn to a structure that burned down due to loose hay that combusted. The barn housed the horse teams used to farm wheat on the Philleo farm in the northern Palouse region. Horse teams consisted of 4 horses per team, 3 teams, with 3 lead horses. (Total of 15 to pull the combine). All horses were fed and cared for in the main thoroughfare of the barn where three draft horse stalls on each side still exist.

This barn is still used to house farm animals, such as 2 horses, 4 steers, 2 goats, 6 ducks, and 2 rabbits. All of these animals are owned by our children and shown at fairs in the 4-H category. It has two stalls in the front, 1 used to house a horse, the other for small animals such as rabbits and ducks. The rear of the barn is open to the pasture and is used for shelter for the steers and goats.

The loft is also used to store 60# grass hay bales that are used to feed our animals and also sold to horse owners. 30-40 ton of hay is stored there from time to time. We do not have an exact date of erection of this barn, but our farm has never been sold and has always been handed down to the next generation.

We are the fifth generation on the farm.

Please note that sections with an "\*" must be completed or your application can not be processed.

If you need assistance completing the form, please contact Michael Houser, State Architectural Historian, at 360-586-3076 or Michael.houser@dahp.wa.gov.

Homesteader: Doc Philleo  
 Son: Edwin Philleo  
 Granddaughter: Phylliss Philleo (McGourin)  
 Great Grandson : John M. McGourin  
 Current Owner & Great Great Grandson: Patrick McGourin.

The main problem for our barn is that the foundation framing the building has failed. It is a very large issue.

**\* Please provide current photos of nominated property (interior and exterior (all four sides)) and a map indicating the location of property. Digital images are preferred (please provide disc) or print on photographic paper.**

<b>OTHER FARMSTEAD BUILDINGS</b>		<i>If building does not exist, please check N/A box * Please provide additional digital photos of secondary buildings/structures</i>					
	<b>ROOF SHAPE</b>	<b>ROOF COVERING</b>	<b>FLOOR PLAN</b>	<b>SIDING</b>	<b>FOUNDATION MATERIAL</b>	<b>OTHER FEATURES: (Color, Trim, etc..)</b>	<b>BUILT DATE</b>
<b>DWELLING</b> <input checked="" type="checkbox"/> Good <input type="checkbox"/> Fair <input type="checkbox"/> Poor <input type="checkbox"/> Altered <input type="checkbox"/> Ruins <input type="checkbox"/> N/A	Standard Peak	metal	two level	stucco over brick	stone	white with green trim	1896
<b>OUTHOUSE</b> <input type="checkbox"/> Good <input type="checkbox"/> Fair <input type="checkbox"/> Poor <input type="checkbox"/> Altered <input type="checkbox"/> Ruins <input checked="" type="checkbox"/> N/A							
<b>CHICKEN COOP</b> <input type="checkbox"/> Good <input type="checkbox"/> Fair <input type="checkbox"/> Poor <input type="checkbox"/> Altered <input type="checkbox"/> Ruins <input checked="" type="checkbox"/> N/A							
<b>MACHINE SHED</b> <input type="checkbox"/> Good <input checked="" type="checkbox"/> Fair <input type="checkbox"/> Poor <input type="checkbox"/> Altered <input type="checkbox"/> Ruins <input type="checkbox"/> N/A	Standard Peak	metal		metal	None	Pole style frame, silver metal color	1960
<b>MILK HOUSE</b> <input type="checkbox"/> Good <input type="checkbox"/> Fair <input type="checkbox"/> Poor <input type="checkbox"/> Altered <input type="checkbox"/> Ruins <input checked="" type="checkbox"/> N/A							

Please note that sections with an "\*" must be completed or your application can not be processed.

If you need assistance completing the form, please contact Michael Houser, State Architectural Historian, at 360-586-3076 or [Michael.houser@dahp.wa.gov](mailto:Michael.houser@dahp.wa.gov).

<b>SILO</b> <input type="checkbox"/> Good <input type="checkbox"/> Fair <input type="checkbox"/> Poor <input type="checkbox"/> Altered <input type="checkbox"/> Ruins <input checked="" type="checkbox"/> N/A							
<b>OTHER: Shop</b> <input type="checkbox"/> Good <input checked="" type="checkbox"/> Fair <input type="checkbox"/> Poor <input type="checkbox"/> Altered <input type="checkbox"/> Ruins <input type="checkbox"/> N/A	Standard Peak	metal		metal	Cement	Pole style frame, silver metal color	1950's
<b>OTHER:</b> <input type="checkbox"/> Good <input type="checkbox"/> Fair <input type="checkbox"/> Poor <input type="checkbox"/> Altered <input type="checkbox"/> Ruins <input type="checkbox"/> N/A							

***Please provide a sketch of the farmstead layout indicating the location of other buildings in relation to the barn. Include an arrow pointing north for directional purposes.***

Return form and additional documentation to: DAHP 1063 S. Capitol Way, Suite 106 Olympia, WA 98504

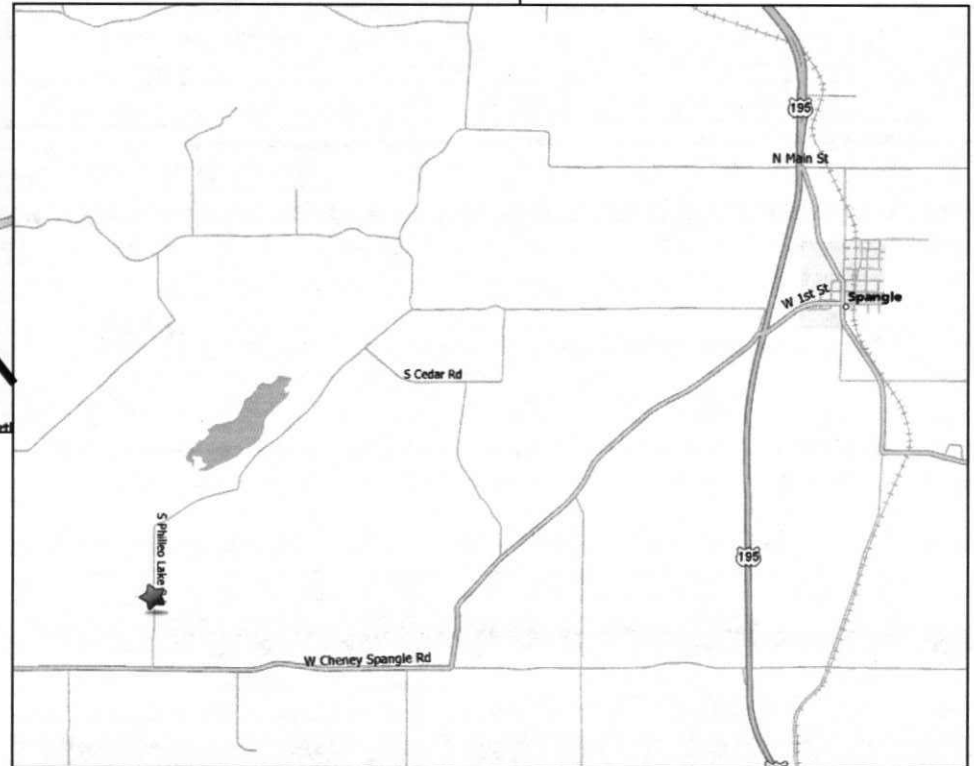
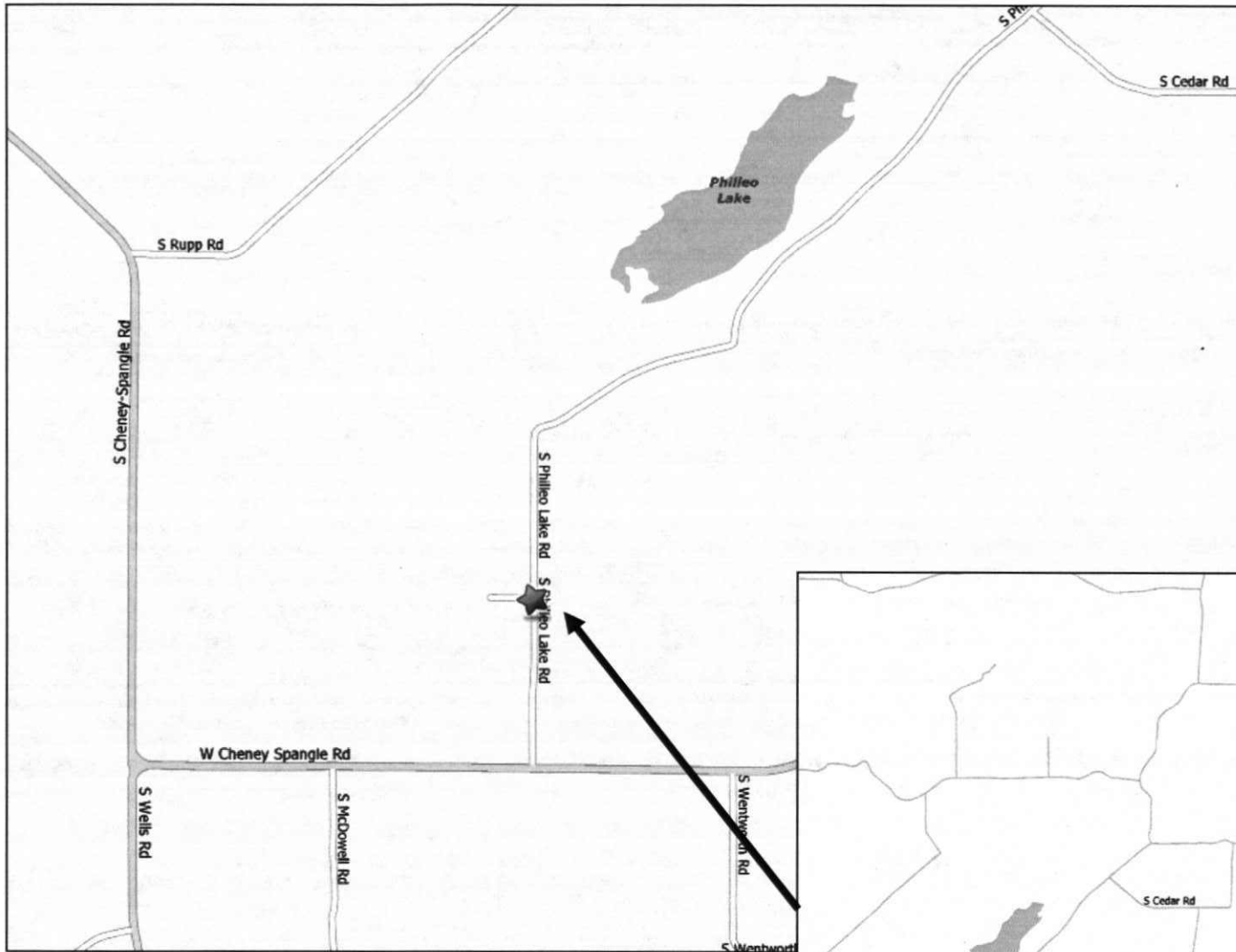

**McGourin Farms Inc.**  
28101 S. Philleo Lake Rd.  
Spangle, WA 99031



28101 S Philleo Lake Rd  
Spangle WA  
99031-9768 US

**Notes:**

Cheney Spangle Road is just to the south of the Barn exactly 1/2 mile

AMBIENCR<sup>™</sup>  
ZOLPIDEM TARTRATE EXTENDED RELEASE C  
125 mg and 250 mg EXTENDED RELEASE TABLETS

# 7-Day Trial Offer

▶ [CLICK HERE](#)

The Philled BARN



All rights reserved. Use Subject to License/Copyright

This map is informational only. No representation is made or warranty given as to its content. User assumes all risk of use. MapQuest and its suppliers assume no responsibility for any loss or delay resulting from such use.

