

SP 559

Only typed forms are accepted. Please send an electronic copy of the completed form.

If you need assistance completing the form, please contact Michael Houser, State Architectural Historian, at 360-586-3076 or Michael.houser@dahp.wa.gov.

Washington State HERITAGE BARN REGISTER 	Farm Name Deep Creek Farm	Property Location Address: 811 N. Deep Creek Rd. City: Medical Lake Zip: 99022
	Historic Name Middleburg Barn	County Spokane
	Owners Name Edmund and Sally Burge	Owner Address Address: Same City: State: Zip:
	Phone: (509) 244-9415 Email: eburge@sisna.com	

BARN	ROOF SHAPE	ROOF COVERING	FLOOR PLAN	SIDING	FOUNDATION MATERIAL	PAINTING/ DECORATION	OTHER BARN FEATURES
CONDITION <input checked="" type="checkbox"/> Good <input type="checkbox"/> Fair <input type="checkbox"/> Poor <input type="checkbox"/> Altered <input type="checkbox"/> Ruins BARN BUILT DATE: 1916	<input type="checkbox"/> Gable <input type="checkbox"/> Broken Gable <input type="checkbox"/> Gambrel <input type="checkbox"/> Hip <input type="checkbox"/> Gothic <input type="checkbox"/> Monitor <input type="checkbox"/> Round <input type="checkbox"/> Dutch <input type="checkbox"/> Conical <input checked="" type="checkbox"/> Other Centric	<input checked="" type="checkbox"/> Asphalt <input type="checkbox"/> Metal <input type="checkbox"/> Wood <input type="checkbox"/> Other CURRENT USE <input checked="" type="checkbox"/> Ag <input type="checkbox"/> Vacant <input type="checkbox"/> Other	<input type="checkbox"/> Square <input type="checkbox"/> Rectangular <input checked="" type="checkbox"/> Round <input type="checkbox"/> Irregular <input type="checkbox"/> L- Shape <input type="checkbox"/> T- Shape Size: Height: 44	<input type="checkbox"/> Metal <input checked="" type="checkbox"/> Wood – Horizontal <input type="checkbox"/> Wood – Board & Batten <input type="checkbox"/> Wood Vertical <input type="checkbox"/> Concrete <input type="checkbox"/> Brick <input type="checkbox"/> Stone <input type="checkbox"/> Asbestos <input type="checkbox"/> Other	<input checked="" type="checkbox"/> Concrete <input type="checkbox"/> Stone <input type="checkbox"/> Brick <input type="checkbox"/> Wood <input type="checkbox"/> None <input type="checkbox"/> Other	Painted? <input type="checkbox"/> No <input checked="" type="checkbox"/> Yes Color: Brown Names/Dates/ Decoration? <input checked="" type="checkbox"/> No <input type="checkbox"/> Yes Describe:	<input type="checkbox"/> Cupola <input type="checkbox"/> Dormer <input type="checkbox"/> Hay Hood <input type="checkbox"/> Ventilator <input type="checkbox"/> Weather Vane <input type="checkbox"/> Lightning Rod <input checked="" type="checkbox"/> Silo <input type="checkbox"/> Milking Shed <input type="checkbox"/> Other

*** PROPERTY HISTORY:** (Expand on the history of the barn/property such as use, original owner, builder, architect, family stories and memories, etc.. add additional pages if necessary)

The original owner was Mr. Middleburg. It was built for a dairy barn. The cows stood in a circle around the silo to be milked. The cows' feet rested on a cork floor. The manure was washed away into a in-ground tank and then pumped onto the meadow in the spring. The barn was lighted by carbide lanterns.

Please provide current photos of nominated property (interior and exterior (all four sides)) and a map indicating the location of property in relationship to major roads. Digital images are preferred (please provide disc) or print on photographic paper.

Only typed forms are accepted. Please send an electronic copy of the completed form.

If you need assistance completing the form, please contact Michael Houser, State Architectural Historian, at 360-586-3076 or Michael.houser@dahp.wa.gov.

OTHER FARMSTEAD BUILDINGS

*If building does not exist, please check N/A box
Provide additional photos of secondary buildings/structures regardless of age.*

	ROOF SHAPE	ROOF COVERING	FLOOR PLAN	SIDING	FOUNDATION MATERIAL	OTHER FEATURES: (Style, Color, Trim, etc..)	BUILT DATE
DWELLING <input type="checkbox"/> Good <input type="checkbox"/> Fair <input type="checkbox"/> Poor <input type="checkbox"/> Altered <input type="checkbox"/> Ruins <input type="checkbox"/> N/A							
OUTHOUSE <input type="checkbox"/> Good <input type="checkbox"/> Fair <input type="checkbox"/> Poor <input type="checkbox"/> Altered <input type="checkbox"/> Ruins <input type="checkbox"/> N/A							
CHICKEN COOP <input type="checkbox"/> Good <input type="checkbox"/> Fair <input type="checkbox"/> Poor <input type="checkbox"/> Altered <input type="checkbox"/> Ruins <input type="checkbox"/> N/A							
MACHINE SHED <input type="checkbox"/> Good <input type="checkbox"/> Fair <input type="checkbox"/> Poor <input type="checkbox"/> Altered <input type="checkbox"/> Ruins <input type="checkbox"/> N/A							
MILK HOUSE <input type="checkbox"/> Good <input type="checkbox"/> Fair <input type="checkbox"/> Poor <input type="checkbox"/> Altered <input type="checkbox"/> Ruins <input type="checkbox"/> N/A							
SILO <input type="checkbox"/> Good <input type="checkbox"/> Fair <input type="checkbox"/> Poor <input type="checkbox"/> Altered <input type="checkbox"/> Ruins <input type="checkbox"/> N/A							
OTHER: <input type="checkbox"/> Good <input checked="" type="checkbox"/> Fair <input type="checkbox"/> Poor <input type="checkbox"/> Altered <input type="checkbox"/> Ruins <input type="checkbox"/> N/A	Hip	Metal	Rectangular	Wood	Stone	Brown	1916
OTHER: <input type="checkbox"/> Good <input type="checkbox"/> Fair <input type="checkbox"/> Poor <input type="checkbox"/> Altered <input type="checkbox"/> Ruins <input type="checkbox"/> N/A							

Please provide a sketch of the farmstead layout indicating the location of other buildings in relation to the barn. Include an arrow pointing north for directional purposes.

Return form and additional documentation to: **DAHP** 1063 S. Capitol Way, Suite 106 Olympia, WA 98504

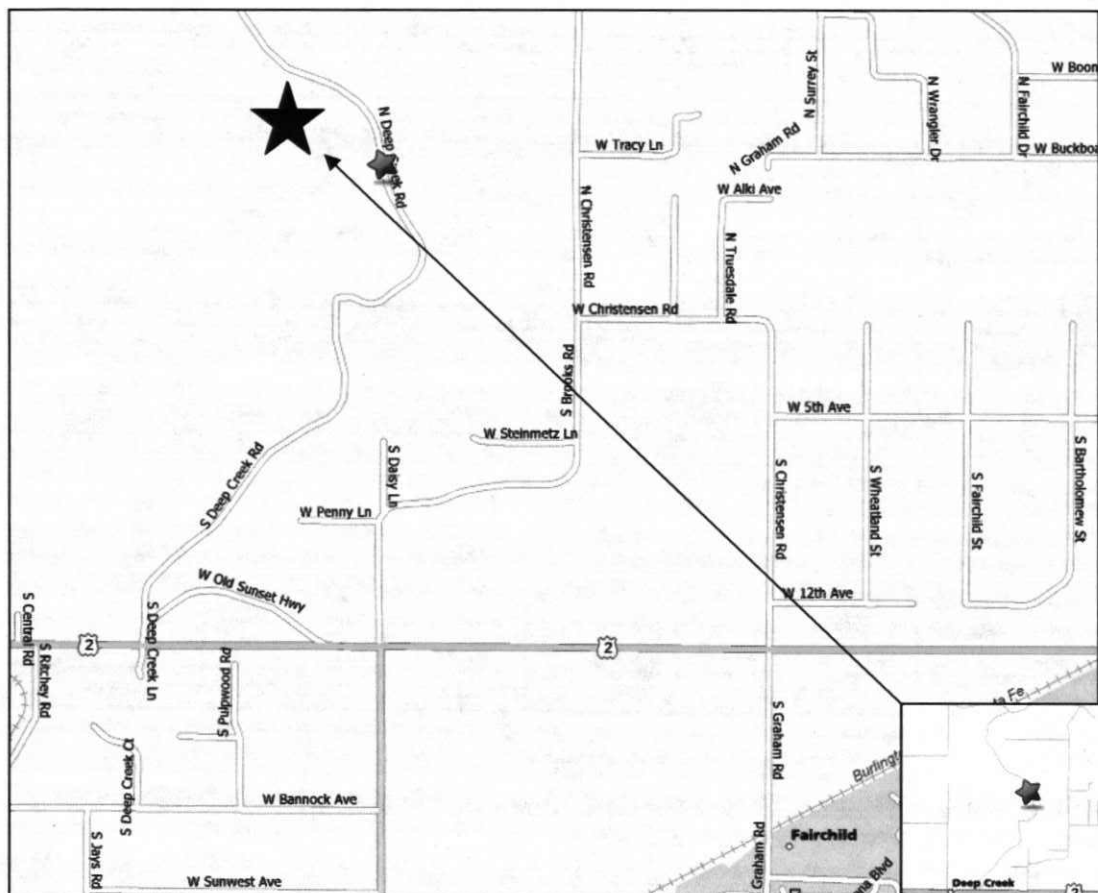

Deep Creek Farm
 811 N. Deep Creek Rd.
 Medical Lake, WA 99022

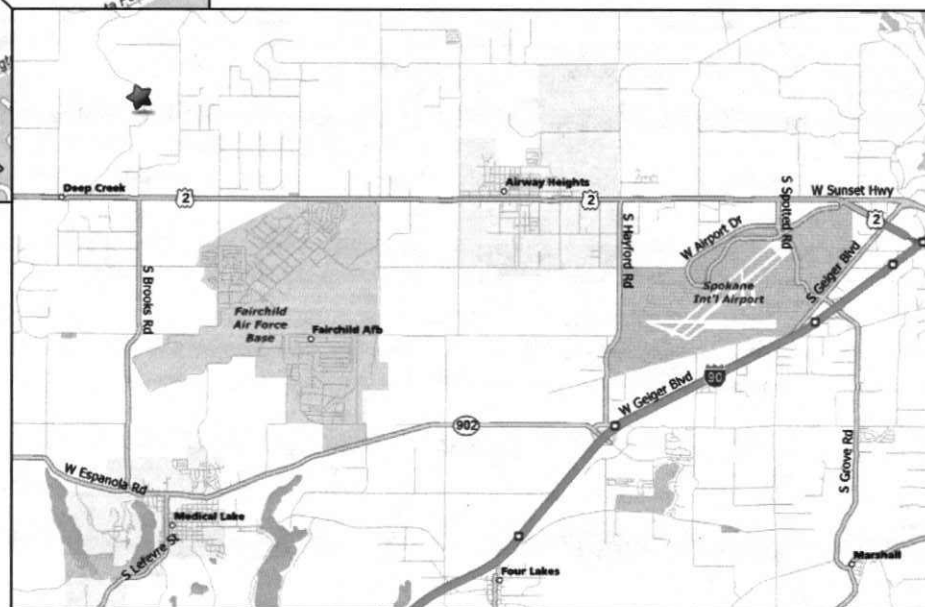



811 N Deep Creek Rd
Medical Lake WA
99022-9655 US

Notes:

Only text visible within note field will print.

What is Your Credit Score?

TransUnion

Experian

Equifax

300 350 400 450 500 550 600 650 700 750 800

You are here (648)

You are here (635)

You are here (618)

[Click Here to Find Out!](#)

Based on your credit report data, this is a numerical depiction of your creditworthiness. High scores are better.

privacymatters.com



All rights reserved. Use Subject to License/Copyright

This map is informational only. No representation is made or warranty given as to its content. User assumes all risk of use. MapQuest and its suppliers assume no responsibility for any loss or delay resulting from such use.



Front View

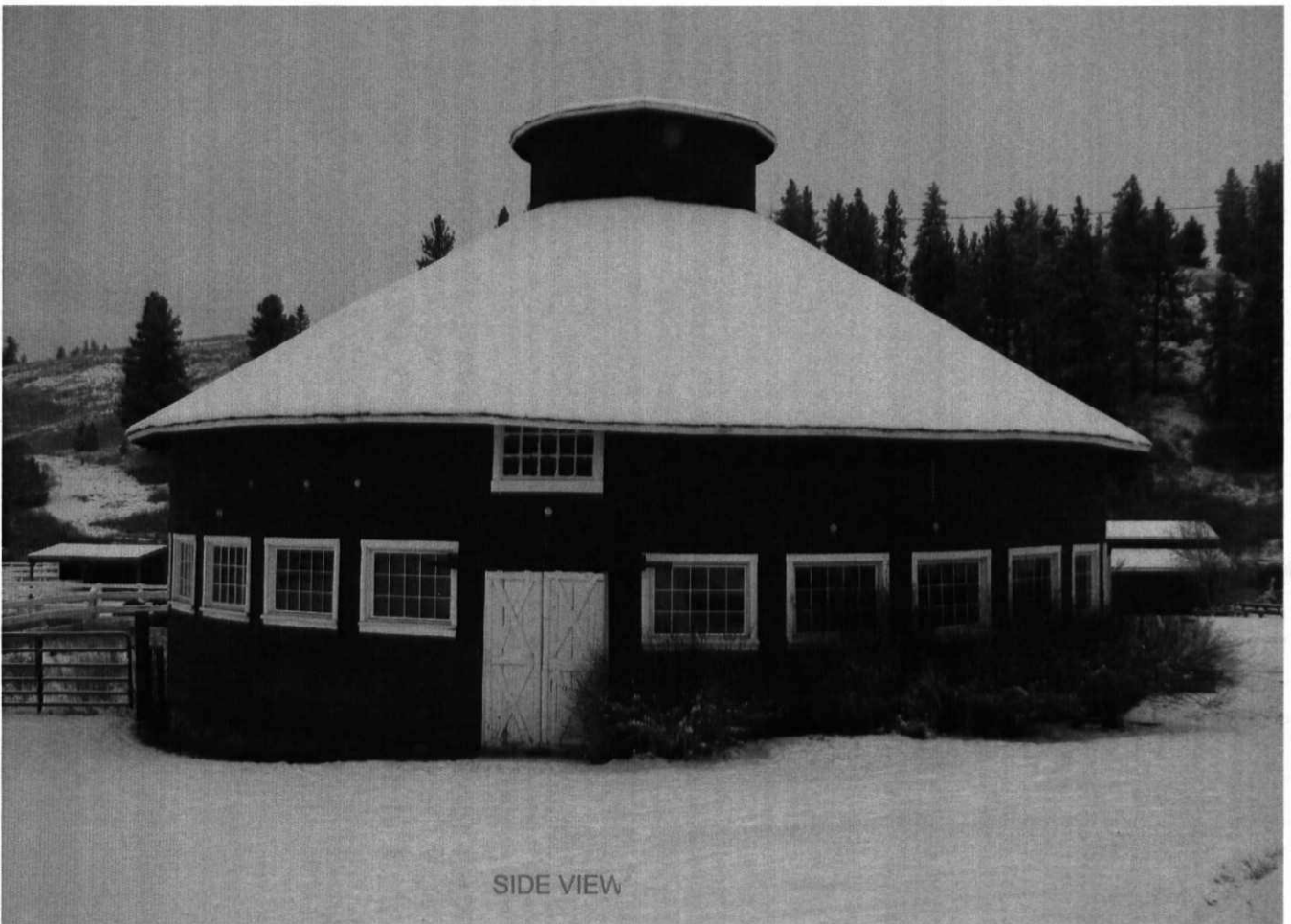

SIDE VIEW

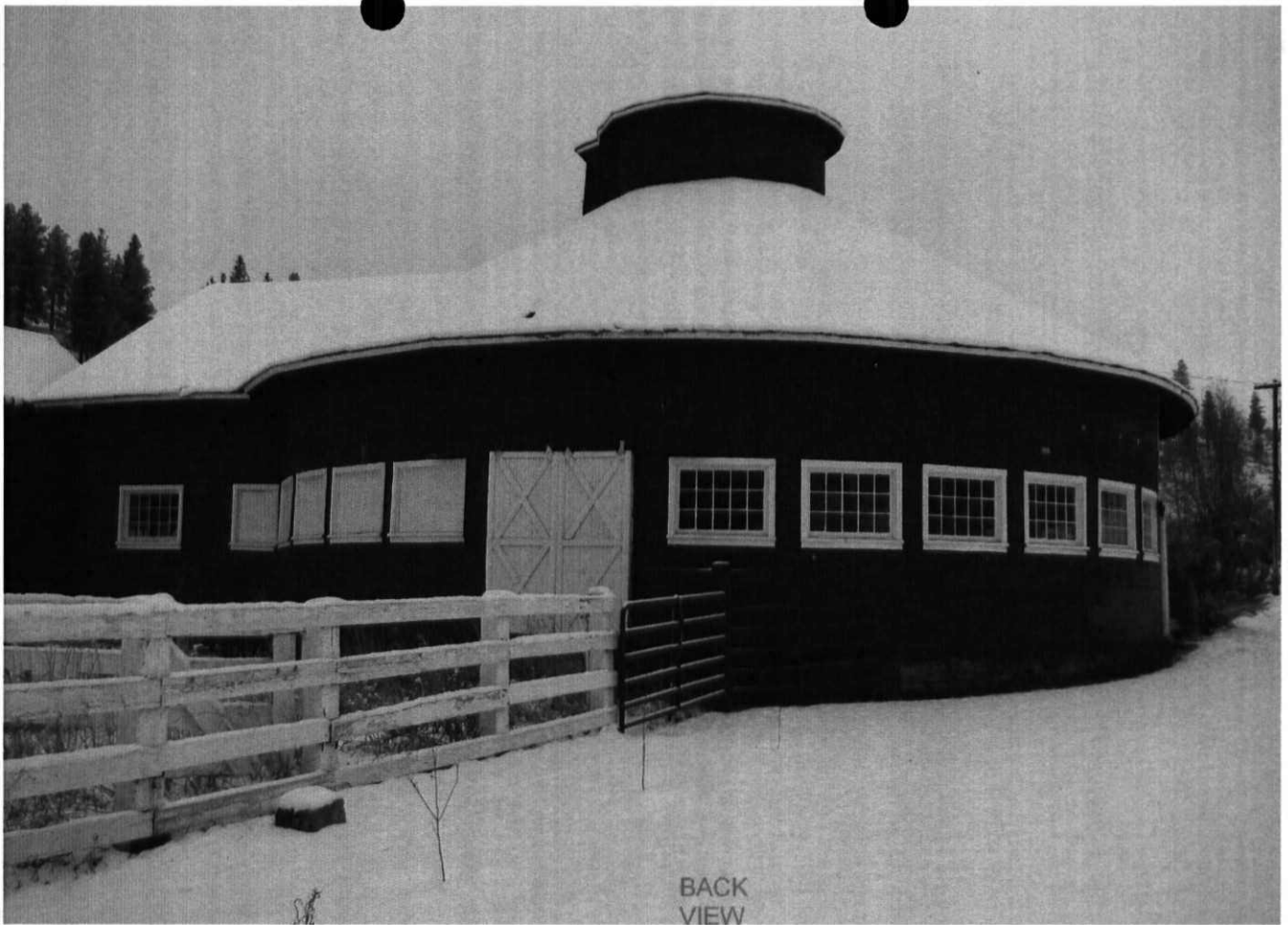

BACK
VIEW

SIDE VIEW





INTERIOR
VIEW



HOLDING
STALL
FOR COW
OR CALF



