

SP 659

Only typed forms are accepted. Please send an electronic copy of the completed form.

If you need assistance completing the form, please contact Michael Houser, State Architectural Historian, at 360-586-3076 or Michael.houser@dahp.wa.gov.

Washington State HERITAGE BARN REGISTER 	Farm Name Larry and Bonnie Busse Farm	Property Location Address: 9003 N. Garfield Rd. City: Spokane Zip: 99224
	Historic Name Alice, Henry, Farm	County Spokane
	Owners Name Larry and Bonnie Busse Phone: (509) 466 4501 Email: larbon@ptera.net	Owner Address Address: 9003 N. Garfield Rd. City: Spokane State: WA Zip: 99224

BARN	ROOF SHAPE	ROOF COVERING	FLOOR PLAN	SIDING	FOUNDATION MATERIAL	PAINTING/ DECORATION	OTHER BARN FEATURES
CONDITION <input type="checkbox"/> Good <input checked="" type="checkbox"/> Fair <input type="checkbox"/> Poor <input type="checkbox"/> Altered <input type="checkbox"/> Ruins BARN BUILT DATE: 1900	<input checked="" type="checkbox"/> Gable <input type="checkbox"/> Broken Gable <input type="checkbox"/> Gambrel <input type="checkbox"/> Hip <input type="checkbox"/> Gothic <input type="checkbox"/> Monitor <input type="checkbox"/> Round <input type="checkbox"/> Dutch <input type="checkbox"/> Conical <input type="checkbox"/> Other	<input type="checkbox"/> Asphalt <input checked="" type="checkbox"/> Metal <input type="checkbox"/> Wood <input type="checkbox"/> Other CURRENT USE <input checked="" type="checkbox"/> Ag <input type="checkbox"/> Vacant <input type="checkbox"/> Other	<input type="checkbox"/> Square <input checked="" type="checkbox"/> Rectangular <input type="checkbox"/> Round <input type="checkbox"/> Irregular <input type="checkbox"/> L- Shape <input type="checkbox"/> T- Shape Size: 40' x 60' Height: 30-40 ft.	<input type="checkbox"/> Metal <input type="checkbox"/> Wood – Horizontal <input type="checkbox"/> Wood – Board & Batten <input checked="" type="checkbox"/> Wood Vertical <input type="checkbox"/> Concrete <input type="checkbox"/> Brick <input type="checkbox"/> Stone <input type="checkbox"/> Asbestos <input type="checkbox"/> Other	<input type="checkbox"/> Concrete <input checked="" type="checkbox"/> Stone <input type="checkbox"/> Brick <input type="checkbox"/> Wood <input type="checkbox"/> None <input type="checkbox"/> Other	Painted? <input type="checkbox"/> No <input checked="" type="checkbox"/> Yes Color: red and white Names/Dates/ Decoration? <input checked="" type="checkbox"/> No <input type="checkbox"/> Yes Describe:	<input type="checkbox"/> Cupola <input checked="" type="checkbox"/> Dormer <input type="checkbox"/> Hay Hood <input type="checkbox"/> Ventilator <input type="checkbox"/> Weather Vane <input type="checkbox"/> Lightning Rod <input checked="" type="checkbox"/> Silo <input checked="" type="checkbox"/> Milking Shed <input type="checkbox"/> Other

*** PROPERTY HISTORY:** (Expand on the history of the barn/property such as use, original owner, builder, architect, family stories and memories, etc.. add additional pages if necessary)

Henry Alice homesteaded our place in the 1880's. He and his dad cut the trees on the place, let them age a year and had them cut into lumber. A barn raising crew framed the barn using notches and pegs. Henry lived in the barn while other logs were drying, so he could build the house.

Please provide current photos of nominated property (interior and exterior (all four sides)) and a map indicating the location of property in relationship to major roads. Digital images are preferred (please provide disc) or print on photographic paper.

Only typed forms are accepted. Please send an electronic copy of the completed form.

If you need assistance completing the form, please contact Michael Houser, State Architectural Historian, at 360-586-3076 or Michael.houser@dahp.wa.gov.

OTHER FARMSTEAD BUILDINGS

If building does not exist, please check N/A box

Provide additional photos of secondary buildings/structures regardless of age.

	ROOF SHAPE (Gable, Hip, etc.)	ROOF COVERING	FLOOR PLAN (Square, L-Shape, Rectangular, etc.)	SIDING	FOUNDATION MATERIAL	OTHER FEATURES: (Style, Color, Trim, etc..)	BUILT DATE
DWELLING <input type="checkbox"/> Good <input checked="" type="checkbox"/> Fair <input type="checkbox"/> Poor <input type="checkbox"/> Altered <input type="checkbox"/> Ruins <input type="checkbox"/> N/A	gable	asphalt	square	wood	rock		early 1900's
OUTHOUSE <input type="checkbox"/> Good <input type="checkbox"/> Fair <input type="checkbox"/> Poor <input type="checkbox"/> Altered <input type="checkbox"/> Ruins <input checked="" type="checkbox"/> N/A							
CHICKEN COOP <input type="checkbox"/> Good <input type="checkbox"/> Fair <input type="checkbox"/> Poor <input type="checkbox"/> Altered <input type="checkbox"/> Ruins <input checked="" type="checkbox"/> N/A							
MACHINE SHED <input type="checkbox"/> Good <input checked="" type="checkbox"/> Fair <input type="checkbox"/> Poor <input type="checkbox"/> Altered <input type="checkbox"/> Ruins <input type="checkbox"/> N/A	gable	metal	rectangle	wood	cement		1950
MILK HOUSE <input type="checkbox"/> Good <input checked="" type="checkbox"/> Fair <input type="checkbox"/> Poor <input type="checkbox"/> Altered <input type="checkbox"/> Ruins <input type="checkbox"/> N/A	gable	metall	rectangle	block	cement		1950
SILO <input type="checkbox"/> Good <input checked="" type="checkbox"/> Fair <input type="checkbox"/> Poor <input type="checkbox"/> Altered <input type="checkbox"/> Ruins <input type="checkbox"/> N/A	dome	metal	round	block	dirt		1950
OTHER: <input type="checkbox"/> Good <input type="checkbox"/> Fair <input type="checkbox"/> Poor <input type="checkbox"/> Altered <input type="checkbox"/> Ruins <input type="checkbox"/> N/A							
OTHER: <input type="checkbox"/> Good <input type="checkbox"/> Fair <input type="checkbox"/> Poor <input type="checkbox"/> Altered <input type="checkbox"/> Ruins <input type="checkbox"/> N/A							

Please provide a sketch of the farmstead layout indicating the location of other buildings in relation to the barn. Include an arrow pointing north for directional purposes.

Return form and additional documentation to: **DAHP** 1063 S. Capitol Way, Suite 106 Olympia, WA 98504



Henry Alice Farmstead
 9003 N. Garfield Rd.
 Spokane, WA 99224

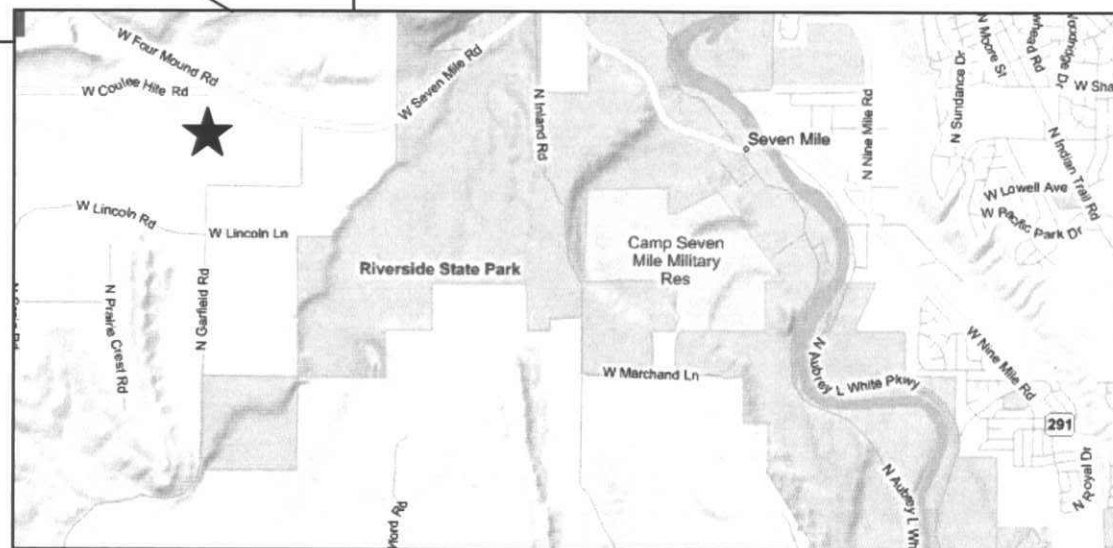



USDA Farm Service Agency
Spokane-Pend Oreille County

Farm : 335

Tract: 305

Operator Larry Busse

March 18, 2009

1 In equals 495 Ft

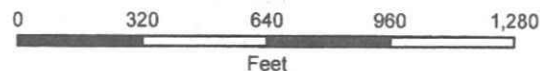

Wetland identifiers do not represent the size, shape, or location of wetlands. They are only a general indication of the area. For specific determinations of the area, exact wetland boundaries and labels, or contact NRCS.

Field Boundaries

Wetland Determination Identifier

● Restricted Use

▽ Limited Restrictions

■ Exempt from Consen
Compliance Provision







Larry Busse
9003 N. Garfield Rd.
Spokane, WA 99224
(509)466-4501

East view of barn



North view of barn



West view of barn



Larry Busse
9003 N. Garfield
Spokane, WA
(509)466-4501

South (front) view
of barn



Pegged and
notched beams.
No nails were
used when
barn was framed.