

SP 663

Only typed forms are accepted. Please send an electronic copy of the completed form.
 If you need assistance completing the form, please contact Michael Houser, State Architectural Historian, at 360-586-3076 or Michael.houser@dahp.wa.gov.

Washington State HERITAGE BARN REGISTER 	Farm Name Girvin Barn	Property Location Address: 6323 E Jamieson Road City: Spokane Zip: 99223
	Historic Name	County Spokane
	Owners Name Shaw Girvin Family Partners Phone: 509-624-0314 Email: girvingw@comcast.net	Owner Address Address: 4203 S. Perry City: Spokane State: WA Zip: 99203

BARN	ROOF SHAPE	ROOF COVERING	FLOOR PLAN	SIDING	FOUNDATION MATERIAL	PAINTING/ DECORATION	OTHER BARN FEATURES
CONDITION <input checked="" type="checkbox"/> Good <input type="checkbox"/> Fair <input type="checkbox"/> Poor <input type="checkbox"/> Altered <input type="checkbox"/> Ruins BARN BUILT DATE: 1904	<input checked="" type="checkbox"/> Gable <input type="checkbox"/> Broken Gable <input type="checkbox"/> Gambrel <input type="checkbox"/> Hip <input type="checkbox"/> Gothic <input type="checkbox"/> Monitor <input type="checkbox"/> Round <input type="checkbox"/> Dutch <input type="checkbox"/> Conical <input type="checkbox"/> Other	<input type="checkbox"/> Asphalt <input checked="" type="checkbox"/> Metal <input type="checkbox"/> Wood <input type="checkbox"/> Other CURRENT USE <input type="checkbox"/> Ag <input type="checkbox"/> Vacant <input checked="" type="checkbox"/> Other Storage	<input checked="" type="checkbox"/> Square <input type="checkbox"/> Rectangular <input type="checkbox"/> Round <input type="checkbox"/> Irregular <input type="checkbox"/> L- Shape <input type="checkbox"/> T- Shape Size: 40' x 40' Height: 25'	<input type="checkbox"/> Metal <input type="checkbox"/> Wood – Horizontal <input checked="" type="checkbox"/> Wood – Board & Batten <input type="checkbox"/> Wood Vertical <input type="checkbox"/> Concrete <input type="checkbox"/> Brick <input type="checkbox"/> Stone <input type="checkbox"/> Asbestos <input type="checkbox"/> Other	<input type="checkbox"/> Concrete <input checked="" type="checkbox"/> Stone <input type="checkbox"/> Brick <input type="checkbox"/> Wood <input type="checkbox"/> None <input type="checkbox"/> Other	Painted? <input type="checkbox"/> No <input checked="" type="checkbox"/> Yes Color: Red Names/Dates/ Decoration? <input checked="" type="checkbox"/> No <input type="checkbox"/> Yes Describe:	<input checked="" type="checkbox"/> Cupola <input type="checkbox"/> Dormer <input type="checkbox"/> Hay Hood <input type="checkbox"/> Ventilator <input type="checkbox"/> Weather Vane <input type="checkbox"/> Lightning Rod <input type="checkbox"/> Silo <input type="checkbox"/> Milking Shed <input checked="" type="checkbox"/> Other 1/2 horse stalls, 1/2 cow stalls on lower level of barn

*** PROPERTY HISTORY:** (Expand on the history of the barn/property such as use, original owner, builder, architect, family stories and memories, etc.. add additional pages if necessary)

House, machine shed and barn were built in 1904. The main arena in the barn was designed to store hay. Side area was used as a milking station.

Please provide current photos of nominated property (interior and exterior (all four sides)) and a map indicating the location of property in relationship to major roads. Digital images are preferred (please provide disc) or print on photographic paper.

Only typed forms are accepted. Please send an electronic copy of the completed form.

If you need assistance completing the form, please contact Michael Houser, State Architectural Historian, at 360-586-3076 or Michael.houser@dahp.wa.gov.

OTHER FARMSTEAD BUILDINGS

If building does not exist, please check N/A box

Provide additional photos of secondary buildings/structures regardless of age.

	ROOF SHAPE (Gable, Hip, etc.)	ROOF COVERING	FLOOR PLAN (Square, L-Shape, Rectangular, etc.)	SIDING	FOUNDATION MATERIAL	OTHER FEATURES: (Style, Color, Trim, etc..)	BUILT DATE
DWELLING <input checked="" type="checkbox"/> Good <input type="checkbox"/> Fair <input type="checkbox"/> Poor <input type="checkbox"/> Altered <input type="checkbox"/> Ruins <input type="checkbox"/> N/A	Gable	Asphalt	Square	Wood	Stone	Tan	1904
OUTHOUSE <input type="checkbox"/> Good <input type="checkbox"/> Fair <input type="checkbox"/> Poor <input type="checkbox"/> Altered <input type="checkbox"/> Ruins <input checked="" type="checkbox"/> N/A							
CHICKEN COOP <input type="checkbox"/> Good <input type="checkbox"/> Fair <input type="checkbox"/> Poor <input type="checkbox"/> Altered <input type="checkbox"/> Ruins <input checked="" type="checkbox"/> N/A							
MACHINE SHED <input checked="" type="checkbox"/> Good <input type="checkbox"/> Fair <input type="checkbox"/> Poor <input type="checkbox"/> Altered <input type="checkbox"/> Ruins <input type="checkbox"/> N/A	Gable	Metal	Rectangular	Wood	Concrete	Red	1920
MILK HOUSE <input type="checkbox"/> Good <input type="checkbox"/> Fair <input type="checkbox"/> Poor <input type="checkbox"/> Altered <input type="checkbox"/> Ruins <input checked="" type="checkbox"/> N/A							
SILO <input checked="" type="checkbox"/> Good <input type="checkbox"/> Fair <input type="checkbox"/> Poor <input type="checkbox"/> Altered <input type="checkbox"/> Ruins <input checked="" type="checkbox"/> N/A							
OTHER: <input type="checkbox"/> Good <input type="checkbox"/> Fair <input type="checkbox"/> Poor <input type="checkbox"/> Altered <input type="checkbox"/> Ruins <input checked="" type="checkbox"/> N/A							
OTHER: <input type="checkbox"/> Good <input type="checkbox"/> Fair <input type="checkbox"/> Poor <input type="checkbox"/> Altered <input type="checkbox"/> Ruins <input checked="" type="checkbox"/> N/A							

Please provide a sketch of the farmstead layout indicating the location of other buildings in relation to the barn. Include an arrow pointing north for directional purposes.

Return form and additional documentation to: DAHP 1063 S. Capitol Way, Suite 106 Olympia, WA 98504

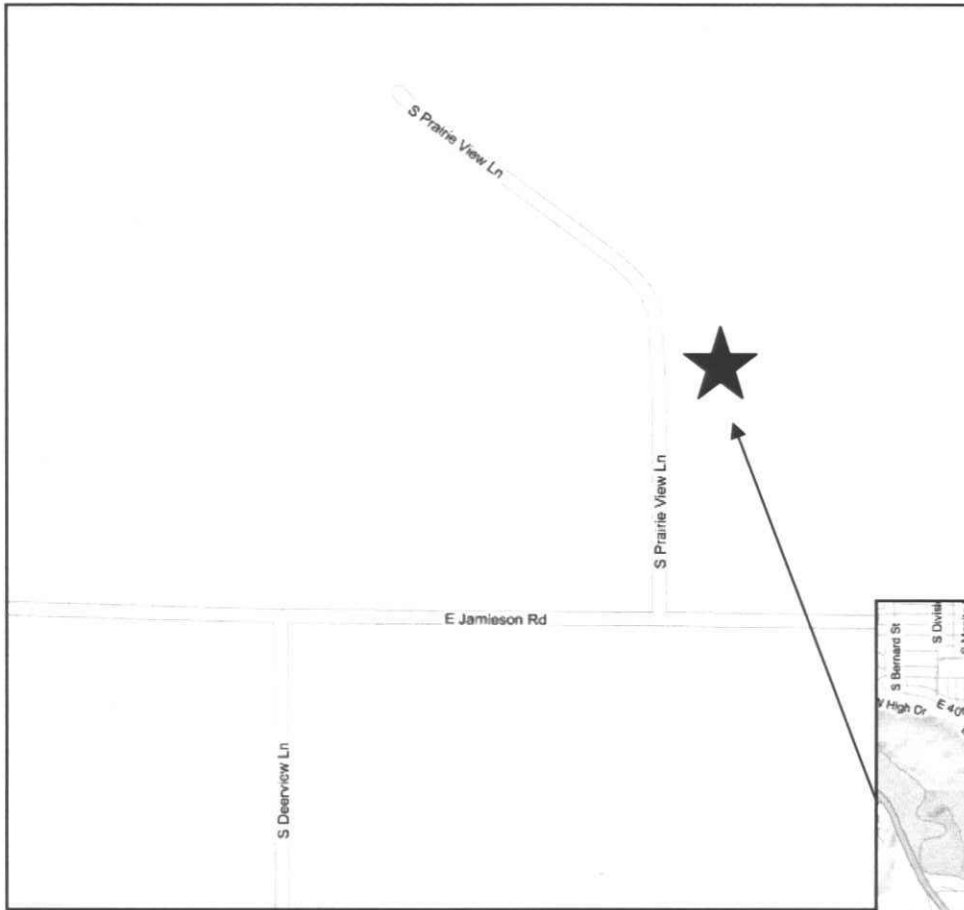

Girvin Barn
6323 E. Jamieson Rd
Spokane, WA 99223

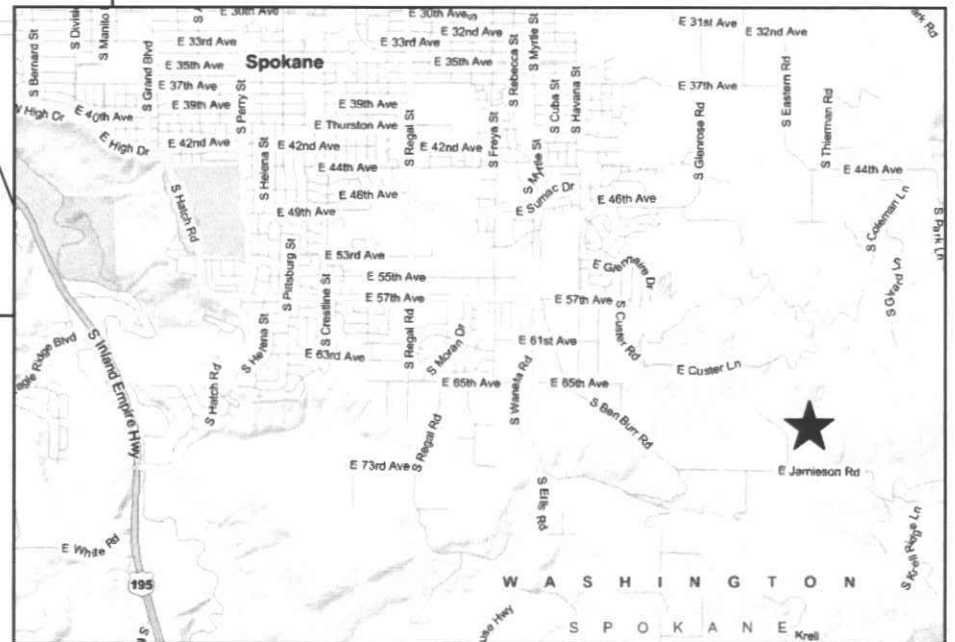

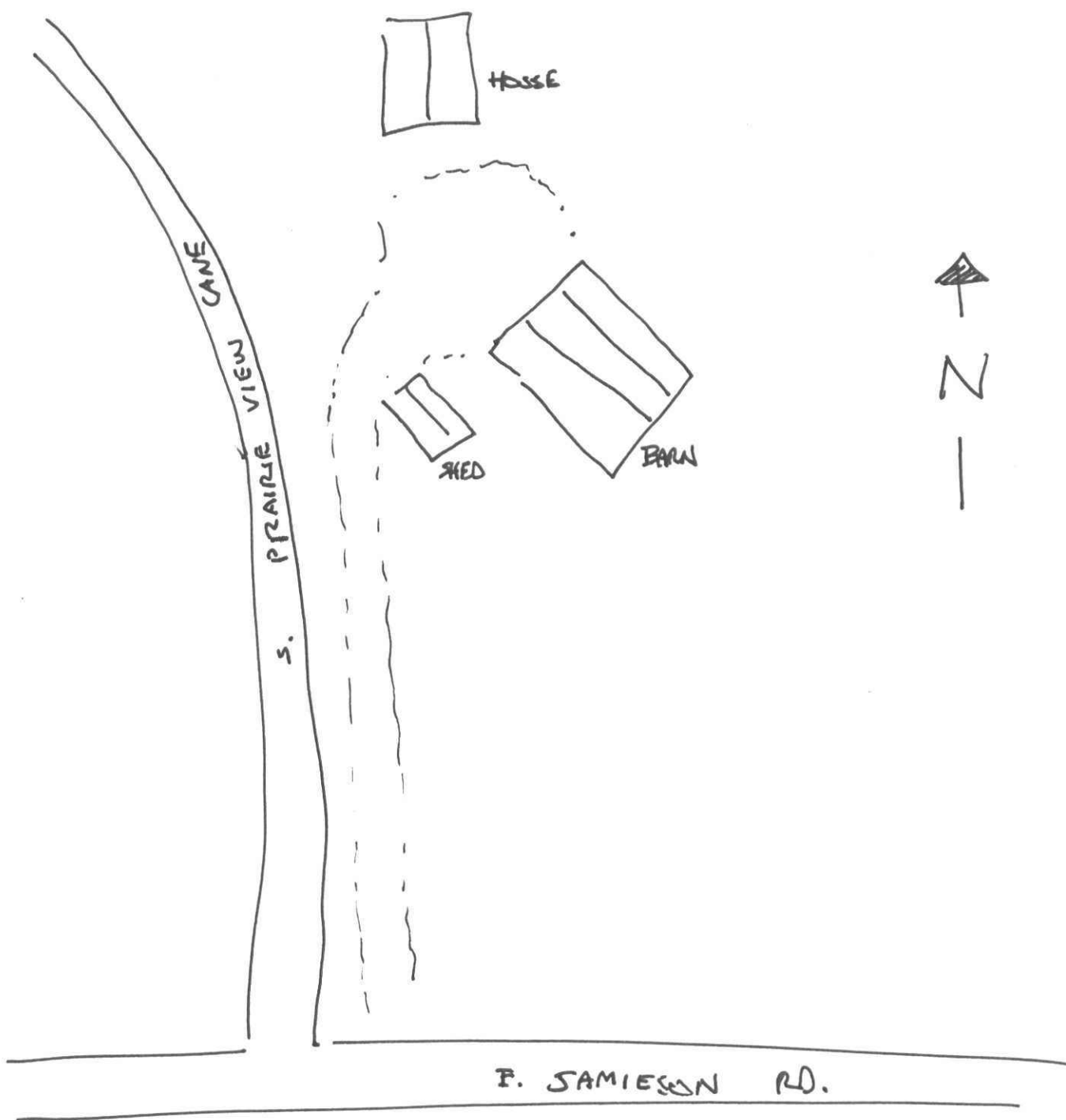

GIRVIN BARN
6323 E. JAMIESON RD
SPOKANE, WA

