

SP 562

Please note that sections with an "\*" must be completed or your application can not be processed.

If you need assistance completing the form, please contact Michael Houser, State Architectural Historian, at 360-586-3076 or [Michael.houser@dahp.wa.gov](mailto:Michael.houser@dahp.wa.gov).

Washington State <b>HERITAGE BARN REGISTER</b> 	<b>Farm Name</b> Finn - Beaven Barn	<b>* Property Location</b> Address: 30211 N. Regal Rd. City: Chattaroy Zip: 99003
	<b>Historic Name</b>	<b>County</b> Spokane
	<b>* Owners Name</b> Dan Finn and Jane Beaven  Phone: 509-238-6578 Email: d4838@aol.com	<b>* Owner Address</b> Address: 30211 N. Regal Rd. City: Chattaroy State: Wa Zip: 99003

BARN	ROOF SHAPE	ROOF COVERING	FLOOR PLAN	SIDING	FOUNDATION MATERIAL	PAINTING/ DECORATION	OTHER BARN FEATURES
<b>CONDITION</b> <input type="checkbox"/> Good <input type="checkbox"/> Fair <input checked="" type="checkbox"/> Poor <input type="checkbox"/> Altered <input type="checkbox"/> Ruins  <b>* BARN BUILT DATE:</b> c 1930	<input checked="" type="checkbox"/> Gable <input type="checkbox"/> Gambrel <input type="checkbox"/> Gothic <input type="checkbox"/> Monitor <input type="checkbox"/> Round <input type="checkbox"/> Shed <input type="checkbox"/> Conical <input type="checkbox"/> Other	<input type="checkbox"/> Asphalt <input type="checkbox"/> Metal <input checked="" type="checkbox"/> Wood <input type="checkbox"/> Other  <b>* CURRENT USE</b> <input type="checkbox"/> Ag <input checked="" type="checkbox"/> Vacant <input type="checkbox"/> Other	<input type="checkbox"/> Square <input checked="" type="checkbox"/> Rectangular <input type="checkbox"/> Round <input type="checkbox"/> Irregular <input type="checkbox"/> L- Shape <input type="checkbox"/> T- Shape Size: 16x21  Height: 20 ft	<input type="checkbox"/> Metal <input type="checkbox"/> Wood – Horizontal <input checked="" type="checkbox"/> Wood – Board & Batten <input type="checkbox"/> Wood Vertical <input type="checkbox"/> Concrete <input type="checkbox"/> Brick <input type="checkbox"/> Stone <input type="checkbox"/> Asbestos <input type="checkbox"/> Other	<input type="checkbox"/> Concrete <input type="checkbox"/> Stone <input type="checkbox"/> Brick <input type="checkbox"/> Wood <input type="checkbox"/> None <input checked="" type="checkbox"/> Other field stone	Painted? <input checked="" type="checkbox"/> No <input type="checkbox"/> Yes Color:  Names/Dates/ Decoration? <input checked="" type="checkbox"/> No <input type="checkbox"/> Yes Describe:	<input checked="" type="checkbox"/> Cupola <input type="checkbox"/> Dormer <input type="checkbox"/> Hay Hood <input type="checkbox"/> Ventilator <input type="checkbox"/> Weather Vane <input type="checkbox"/> Lightning Rod <input type="checkbox"/> Silo <input type="checkbox"/> Milking Shed <input type="checkbox"/> Other Has fallen off and is on the ground.

**\* PROPERTY HISTORY: (Expand on the history of the barn/property such as use, builder, architect, family stories and memories, etc.. add additional pages if necessary)**

This barn is on 20 acres of land in the riparian area of the Little Spokane River watershed. As this river has wild and scenic designation, land which feeds it is of great importance. The barn itself sits on the edge of a small seasonal creek that flows into Owen Lake (see map). While I was researching our property, one oldtimer told me that the land was once bought by a member of the Colville tribe, using tribal money from uranium rights sales, who then ran a small dairy here. There are remnants in the barn of stanchions used to hold cows during milking. Another historian told me of family who owned this land and may have lived in the barn for a short while after their house burned down. In addition there seems to have been an apiary here at some point as the loft of the barn holds numerous supers and other bee hive equipment. There were two active hives here when we moved here and they continue to house wild swarms periodically. Initially we became concerned about the condition of this barn when we noticed that some wooden parts were in contact with earth. (Many points of the barn perch securely on large field stones.) Visitors who had worked on a farm restoration project in the Bellingham area commented that it was a good example of a structure built using materials at hand and noted the evidence of hand hewn wood. (During a recent kitchen remodelling project, we found further evidence of this as hand hewn timbers; some with bark remaining were used as roof support in the oldest part of the house, built circa 1925.) Recently many of the wooden roof shingles have come off and we realize it is just a matter of time before this barn moulders and falls. We really would like to restore it as it is a charming example of building done by practical and utilitarian people of the past.

Please note that sections with an "\*" must be completed or your application can not be processed.

If you need assistance completing the form, please contact Michael Houser, State Architectural Historian, at 360-586-3076 or [Michael.houser@dahp.wa.gov](mailto:Michael.houser@dahp.wa.gov).

**\* Please provide current photos of nominated property (interior and exterior (all four sides)) and a map indicating the location of property. Digital images are preferred (please provide disc) or print on photographic paper.**

OTHER FARMSTEAD BUILDINGS		If building does not exist, please check N/A box * Please provide additional digital photos of secondary buildings/structures					
	ROOF SHAPE	ROOF COVERING	FLOOR PLAN	SIDING	FOUNDATION MATERIAL	OTHER FEATURES: (Color, Trim, etc..)	BUILT DATE
<b>DWELLING</b> <input checked="" type="checkbox"/> Good <input type="checkbox"/> Fair <input type="checkbox"/> Poor <input type="checkbox"/> Altered <input type="checkbox"/> Ruins <input type="checkbox"/> N/A	Gable	wood shake	U shape	wood	concrete	redwood stained cedar siding	Update and re-model 1985
<b>OUTHOUSE</b> <input type="checkbox"/> Good <input type="checkbox"/> Fair <input type="checkbox"/> Poor <input type="checkbox"/> Altered <input type="checkbox"/> Ruins <input checked="" type="checkbox"/> N/A							
<b>CHICKEN COOP</b> <input type="checkbox"/> Good <input type="checkbox"/> Fair <input type="checkbox"/> Poor <input type="checkbox"/> Altered <input type="checkbox"/> Ruins <input checked="" type="checkbox"/> N/A							
<b>MACHINE SHED</b> <input type="checkbox"/> Good <input type="checkbox"/> Fair <input type="checkbox"/> Poor <input type="checkbox"/> Altered <input type="checkbox"/> Ruins <input checked="" type="checkbox"/> N/A							
<b>MILK HOUSE</b> <input type="checkbox"/> Good <input type="checkbox"/> Fair <input type="checkbox"/> Poor <input type="checkbox"/> Altered <input type="checkbox"/> Ruins <input checked="" type="checkbox"/> N/A							
<b>SILO</b> <input type="checkbox"/> Good <input type="checkbox"/> Fair <input type="checkbox"/> Poor <input type="checkbox"/> Altered <input type="checkbox"/> Ruins <input checked="" type="checkbox"/> N/A							
<b>OTHER: 2 wood sheds</b> <input checked="" type="checkbox"/> Good <input type="checkbox"/> Fair <input checked="" type="checkbox"/> Poor <input type="checkbox"/> Altered <input type="checkbox"/> Ruins <input type="checkbox"/> N/A							

Please note that sections with an "\*" must be completed or your application can not be processed.

If you need assistance completing the form, please contact Michael Houser, State Architectural Historian, at 360-586-3076 or [Michael.houser@dahp.wa.gov](mailto:Michael.houser@dahp.wa.gov).

<b>OTHER: pump house</b> <input checked="" type="checkbox"/> Good <input type="checkbox"/> Fair <input type="checkbox"/> Poor <input type="checkbox"/> Altered <input type="checkbox"/> Ruins <input type="checkbox"/> N/A							
<b><i>Please provide a sketch of the farmstead layout indicating the location of other buildings in relation to the barn. Include an arrow pointing north for directional purposes.</i></b>							

Return form and additional documentation to: **DAHP** 1063 S. Capitol Way, Suite 106 Olympia, WA 98504

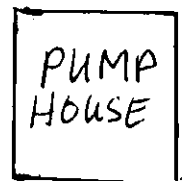
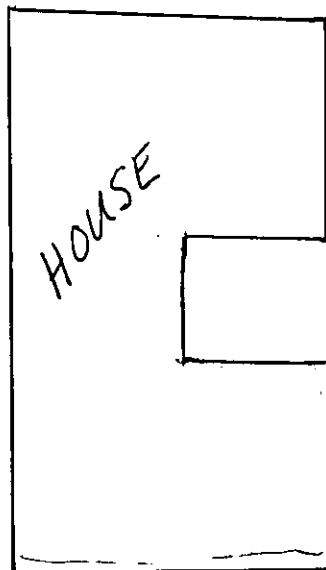
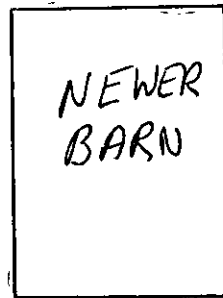

NOT TO SCALE



newer  
BARN

HOUSE

2.9027

OLD ↑  
BARN

2.9028

2.9029

2.9006

2.900







IMAGE FLOWN IN 2004

MAP PRODUCTION DATE: October 18, 2007

## SPOKANE COUNTY ASSESSORS GEOGRAPHIC INFORMATION SYSTEMS



-  PARCELS
-  SUBDIVISION LOTS/BLOCKS
-  SUBDIVISION BOUNDARIES
-  QUARTER SECTIONS

# SEC.15 T28N R43E.W.M QUARTER SECTION ORTHO IMAGE

PRODUCED FOR ASSESSOR OFFICE PURPOSES ONLY

Ownership Data Base Copyright Spokane County Assessors Office. All Rights Reserved

This map is provided 'AS IS', without any warranty of any type whether expressed or implied, including any warranties of merchantability or fitness for a particular purpose. The Data contained on this map is compiled from numerous sources, and is subject to constant change, and its accuracy cannot be guaranteed. The County does not warrant that the information contained on the map will meet the requirements of the recipient. The recipient assumes the entire risk, including quality and usefulness of any data contained on this map. The County will not be liable in any event for any damages of any kind whatsoever resulting from use of this map. This limitation of the County's liability will apply regardless of the form of action, whether in contract or tort.

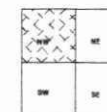

Map Scale  
1 inch = 200 ft

NE CO.  
NGTON

Miles 7 14

MAPS  
ACOMA, WASH.  
EATTLE, WASH.

THE BEST OF  
N°  
CITY, SECTION  
ALINE

**SPOKANE CO.**



STEVENS COUNTY



T.29N.

T.28N.

N  
15 28 43

ROWEN  
LAKE

BEAR  
LAKE  
CO.  
PARK

→  
barn

OWEN  
LAKE



5029





East side



north side



West side



South side





hand notched







hand hewn timber



barn is sitting on  
such field stones





old cattle stanchion -  
the barn door  
(off - on the floor)









1044

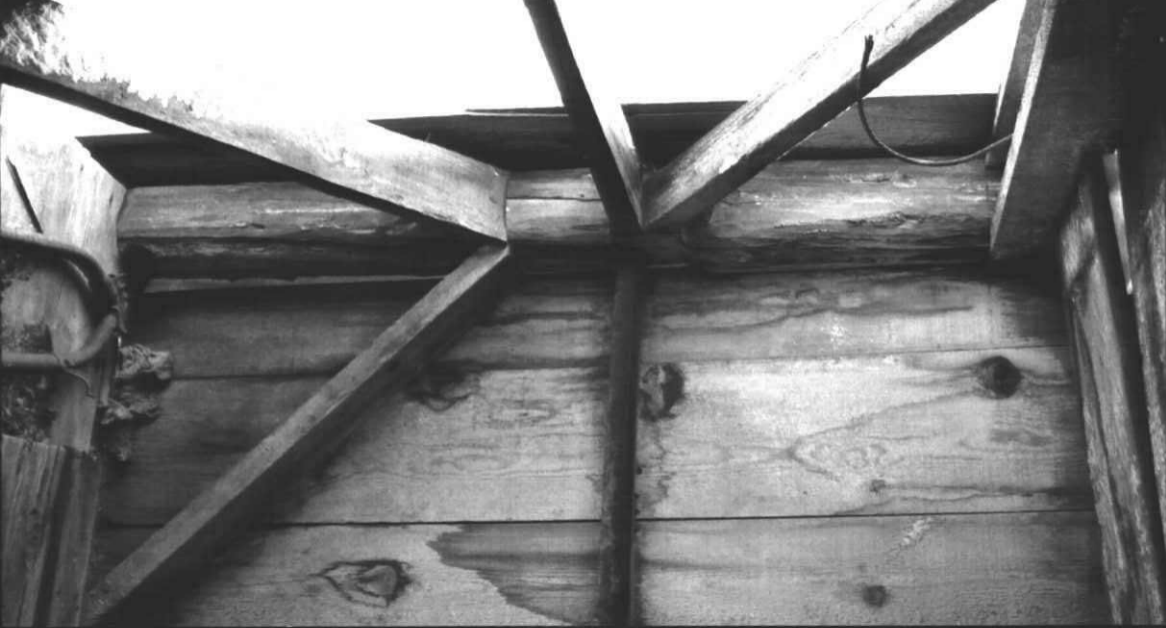



loft with supers  
for bee hives



interior view of roof  
from the loft



the Cupola

wood shake &  
galvanized tin



Older barn in distance



Old barn several  
years ago -  
roof is more intact