

SP 654

Only typed forms are accepted. Please send an electronic copy of the completed form.

If you need assistance completing the form, please contact Michael Houser, State Architectural Historian, at 360-586-3076 or Michael.houser@dahp.wa.gov.

Washington State HERITAGE BARN REGISTER 	Farm Name A and B Farms, Inc	Property Location Address: 1626 W Powers Rd City: Rosalia Zip: 99021
	Historic Name Babb, Albert & Mary, Farm	County Spokane
	Owners Name Bobbi Babb, Judy Babb, Linda Daniels Phone: 509 467-3424 Email: lindypepper@yahoo.com	Owner Address Address: 1626 W Powers Rd City: Rosalia State: WA Zip: 99021

BARN	ROOF SHAPE	ROOF COVERING	FLOOR PLAN	SIDING	FOUNDATION MATERIAL	PAINTING/ DECORATION	OTHER BARN FEATURES
CONDITION <input type="checkbox"/> Good <input type="checkbox"/> Fair <input checked="" type="checkbox"/> Poor <input type="checkbox"/> Altered <input type="checkbox"/> Ruins BARN BUILT DATE: c.1900	<input checked="" type="checkbox"/> Gable <input type="checkbox"/> Broken Gable <input type="checkbox"/> Gambrel <input type="checkbox"/> Hip <input type="checkbox"/> Gothic <input type="checkbox"/> Monitor <input type="checkbox"/> Round <input type="checkbox"/> Dutch <input type="checkbox"/> Conical <input type="checkbox"/> Other	<input type="checkbox"/> Asphalt <input checked="" type="checkbox"/> Metal <input type="checkbox"/> Wood <input type="checkbox"/> Other CURRENT USE <input type="checkbox"/> Ag <input checked="" type="checkbox"/> Vacant <input type="checkbox"/> Other	<input type="checkbox"/> Square <input checked="" type="checkbox"/> Rectangular <input type="checkbox"/> Round <input type="checkbox"/> Irregular <input type="checkbox"/> L- Shape <input type="checkbox"/> T- Shape Size: 48'x40' Height: 30ft	<input type="checkbox"/> Metal <input type="checkbox"/> Wood – Horizontal <input type="checkbox"/> Wood – Board & Batten <input checked="" type="checkbox"/> Wood Vertical <input type="checkbox"/> Concrete <input type="checkbox"/> Brick <input type="checkbox"/> Stone <input type="checkbox"/> Asbestos <input type="checkbox"/> Other	<input type="checkbox"/> Concrete <input checked="" type="checkbox"/> Stone <input type="checkbox"/> Brick <input type="checkbox"/> Wood <input type="checkbox"/> None <input type="checkbox"/> Other	Painted? <input checked="" type="checkbox"/> No <input type="checkbox"/> Yes Color: Names/Dates/ Decoration? <input checked="" type="checkbox"/> No <input type="checkbox"/> Yes Describe:	<input type="checkbox"/> Cupola <input type="checkbox"/> Dormer <input type="checkbox"/> Hay Hood <input type="checkbox"/> Ventilator <input type="checkbox"/> Weather Vane <input type="checkbox"/> Lightning Rod <input type="checkbox"/> Silo <input type="checkbox"/> Milking Shed <input type="checkbox"/> Other hay mangers on both sides

*** PROPERTY HISTORY:** (Expand on the history of the barn/property such as use, original owner, builder, architect, family stories and memories, etc.. add additional pages if necessary)

Our family farm is registered as a Wash.State Centennial Farm established by Albert & Mary Babb in 1878. In the late 1940's, we purchased land from Clarence Martin, governor of Washington State from 1933 to 1940. This barn is a lonely reminder of a homestead that is long gone. There are no other buildings around it now. This is the last remaining structure of a homestead. We believe the Martin property was previously owned by a family named Scott.

Please provide current photos of nominated property (interior and exterior (all four sides)) and a map indicating the location of property in relationship to major roads. Digital images are preferred (please provide disc) or print on photographic paper.

Only typed forms are accepted. Please send an electronic copy of the completed form.

If you need assistance completing the form, please contact Michael Houser, State Architectural Historian, at 360-586-3076 or Michael.houser@dahp.wa.gov.

OTHER FARMSTEAD BUILDINGS

If building does not exist, please check N/A box

Provide additional photos of secondary buildings/structures regardless of age.

	ROOF SHAPE (Gable, Hip, etc.)	ROOF COVERING	FLOOR PLAN (Square, L-Shape, Rectangular, etc.)	SIDING	FOUNDATION MATERIAL	OTHER FEATURES: (Style, Color, Trim, etc.)	BUILT DATE
DWELLING <input checked="" type="checkbox"/> Good <input type="checkbox"/> Fair <input type="checkbox"/> Poor <input type="checkbox"/> Altered <input type="checkbox"/> Ruins <input checked="" type="checkbox"/> N/A	regular	shingles	rectangular	vinyl	cement		moved unto property in the 50's
OUTHOUSE <input type="checkbox"/> Good <input type="checkbox"/> Fair <input type="checkbox"/> Poor <input type="checkbox"/> Altered <input type="checkbox"/> Ruins <input checked="" type="checkbox"/> N/A							
CHICKEN COOP <input checked="" type="checkbox"/> Good <input type="checkbox"/> Fair <input type="checkbox"/> Poor <input type="checkbox"/> Altered <input type="checkbox"/> Ruins <input type="checkbox"/> N/A	regular	metal	rectangular	wood	cement		Unknown
MACHINE SHED <input type="checkbox"/> Good <input checked="" type="checkbox"/> Fair <input type="checkbox"/> Poor <input type="checkbox"/> Altered <input type="checkbox"/> Ruins <input type="checkbox"/> N/A	regular	metal	rectangular	wood	cement		Unknown
MILK HOUSE <input type="checkbox"/> Good <input type="checkbox"/> Fair <input type="checkbox"/> Poor <input type="checkbox"/> Altered <input type="checkbox"/> Ruins <input checked="" type="checkbox"/> N/A							
SILO <input type="checkbox"/> Good <input type="checkbox"/> Fair <input type="checkbox"/> Poor <input type="checkbox"/> Altered <input type="checkbox"/> Ruins <input checked="" type="checkbox"/> N/A							
OTHER: haybarn <input type="checkbox"/> Good <input checked="" type="checkbox"/> Fair <input type="checkbox"/> Poor <input type="checkbox"/> Altered <input type="checkbox"/> Ruins <input type="checkbox"/> N/A	regular	metal	rectangular	metal	cement		1960's
OTHER: shop <input checked="" type="checkbox"/> Good <input type="checkbox"/> Fair <input type="checkbox"/> Poor <input type="checkbox"/> Altered <input type="checkbox"/> Ruins <input type="checkbox"/> N/A	regular	shingle	rectangular	wood	cement		Unknown

Please provide a sketch of the farmstead layout indicating the location of other buildings in relation to the barn. Include an arrow pointing north for directional purposes.

Return form and additional documentation to: DAHP 1063 S. Capitol Way, Suite 106 Olympia, WA 98504

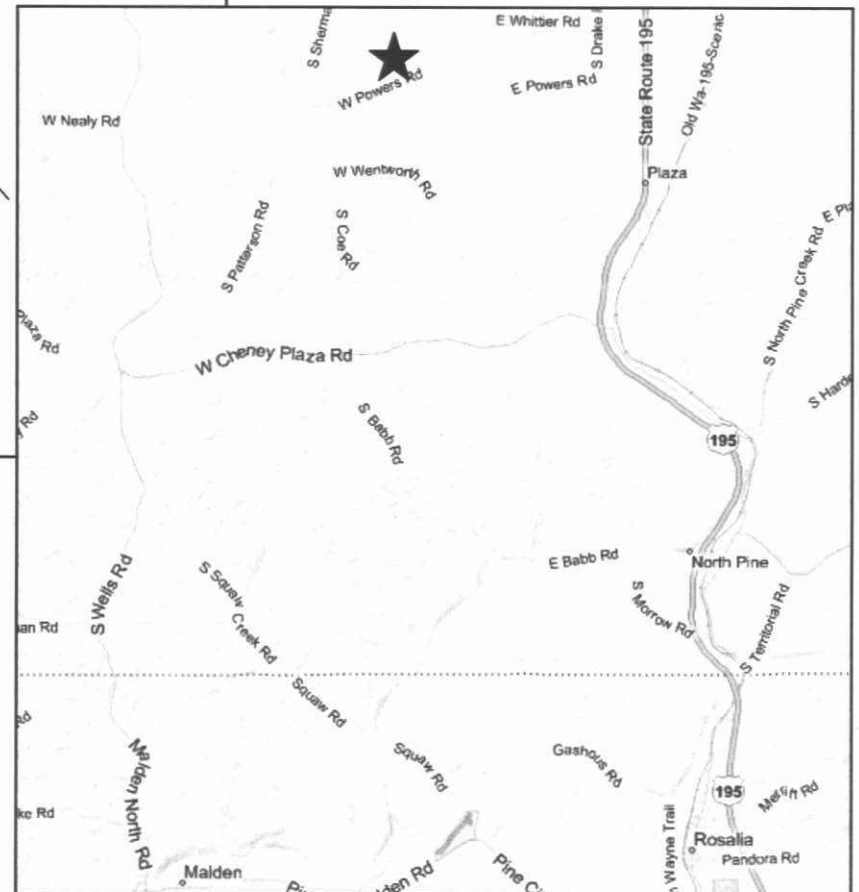
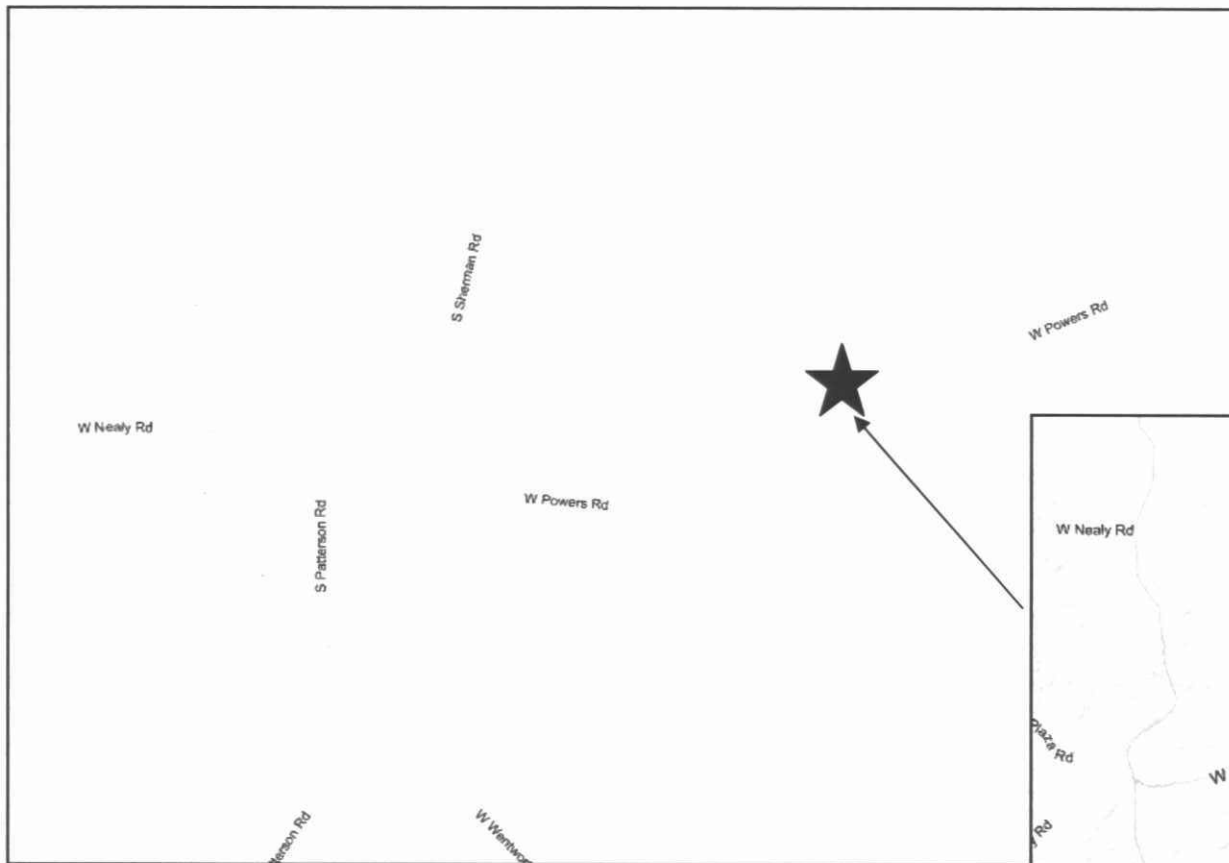

Albert & Elizabeth Babb Farm
 1626 W Powers Rd
 Rosalia, WA 99170



The Babb Farm

Spokane

Owners: John M. and Elizabeth A. Babb

Location of Farm: 13.5 miles southeast of Cheney on Nealey Rd.

<i>Dates of Ownership</i>	<i>Name</i>	<i>Relationship to Current Owner</i>
1878 - 1916	Albert and Mary Elizabeth Babb	Grandparents
1916 - 1955	John Babb, Sr.	Father
1955 - 1962	Eunice Irene Babb	Mother
1962 - Present	John M. and Elizabeth A. Babb	

Albert Barton Babb was one of the first settlers in the Rock Creek District near Chapman Lake. In 1878, at age 34, he filed a 160-acre homestead claim. Early improvements included a box house with a kitchen addition. He also built a barn, planted 100 fruit trees, broke 60 acres of land, and fenced 120 acres of land. Babb married Mary Elizabeth Nealey near Danville, Iowa in 1867. They travelled to San Francisco by boat and then to Oregon where they lived for seven years before coming to Washington Territory in 1876. The Babbs had nine children; four were born on the homestead. Youngest son John purchased the homestead in 1916.

Acres in original parcel: 160 **Acres still retained:** 160

Crops or livestock raised: 1889 - Wheat, oats, hay, vegetables, fruit, draft horses; 1988 - Wheat, barley, oats, peas, lentils, alfalfa, triticale, beef cattle

Additional information: In spring, Nez Perce Indians often camped on the meadow near the Babb home on their way from Idaho to dig camas and other roots in Washington and the younger Babb children would play with the Nez Perce children. Albert Babb owned and operated one of the first sawmills in the area. In May 1879 he began producing lumber from a port-

able sawmill near Spangle, later moving it to Rock Creek. In 1884 he replaced the original box house he had built with a frame house, one of the first in the area. The house featured a dance hall on the second floor and was a favorite neighborhood gathering place. Babb also raised prize-winning Clydesdale draft horses. The 2,700-acre farm has been operated by David Babb since 1973 when his father John retired after thirty years of farming.

