

SP 558

Only typed forms accepted. Please send an electronic copy of the completed form.

If you need assistance completing the form, please contact Michael Houser, State Architectural Historian, at 360-586-3076 or Michael.houser@dahp.wa.gov.

Washington State HERITAGE BARN REGISTER 	Farm Name Alberthal Barn	Property Location Address: 31411 N. Monroe Road City: Deer Park Zip: 99006
	Historic Name Alberthal Barn	County Spokane
	Owners Name Neil & Mikie Gaber Phone: 509-276-2470 Email: mgaber@icehouse.net	Owner Address Address: 6510 W. Burroughs Road City: Deer Park State: WA Zip: 99006

BARN	ROOF SHAPE	ROOF COVERING	FLOOR PLAN	SIDING	FOUNDATION MATERIAL	PAINTING/ DECORATION	OTHER BARN FEATURES
CONDITION <input type="checkbox"/> Good <input type="checkbox"/> Fair <input checked="" type="checkbox"/> Poor <input type="checkbox"/> Altered <input type="checkbox"/> Ruins BARN BUILT DATE: c. 1925	<input type="checkbox"/> Gable <input checked="" type="checkbox"/> Broken Gable <input type="checkbox"/> Gambrel <input type="checkbox"/> Bow Truss <input type="checkbox"/> Gothic <input type="checkbox"/> Monitor <input type="checkbox"/> Round <input type="checkbox"/> Shed <input type="checkbox"/> Conical <input type="checkbox"/> Other	<input type="checkbox"/> Asphalt <input checked="" type="checkbox"/> Metal <input checked="" type="checkbox"/> Wood <input type="checkbox"/> Other Original shakes later covered with corrugated metal CURRENT USE <input checked="" type="checkbox"/> Ag <input type="checkbox"/> Vacant <input type="checkbox"/> Other	<input type="checkbox"/> Square <input checked="" type="checkbox"/> Rectangular <input type="checkbox"/> Round <input type="checkbox"/> Irregular <input type="checkbox"/> L- Shape <input type="checkbox"/> T- Shape Size: 41 x 63 ft. Height: approx. 40 ft,	<input type="checkbox"/> Metal <input type="checkbox"/> Wood – Horizontal <input checked="" type="checkbox"/> Wood – Board & Batten <input checked="" type="checkbox"/> Wood Vertical <input type="checkbox"/> Concrete <input type="checkbox"/> Brick <input type="checkbox"/> Stone <input type="checkbox"/> Asbestos <input type="checkbox"/> Other	<input checked="" type="checkbox"/> Concrete <input checked="" type="checkbox"/> Stone <input type="checkbox"/> Brick <input type="checkbox"/> Wood <input type="checkbox"/> None <input type="checkbox"/> Other	Painted? <input type="checkbox"/> No <input checked="" type="checkbox"/> Yes Color: used to be red Names/Dates/ Decoration? <input checked="" type="checkbox"/> No <input type="checkbox"/> Yes Describe:	<input type="checkbox"/> Cupola <input type="checkbox"/> Dormer <input checked="" type="checkbox"/> Hay Hood <input type="checkbox"/> Ventilator <input type="checkbox"/> Weather Vane <input type="checkbox"/> Lightning Rod <input type="checkbox"/> Silo <input type="checkbox"/> Milking Shed <input type="checkbox"/> Other

*** PROPERTY HISTORY:** (Expand on the history of the barn/property such as use, builder, architect, family stories and memories, etc.. add additional pages if necessary)

The only thing we know for sure is that it was built pre-1950. My dad (Jack Hopkins) purchased the adjoining farm in 1953 and the Alberthal barn was old and run down even at that point. My dad then purchased the Alberthal farm in 1960 and repaired the barn enough that he could store hay in it and grain in the old granary. My dad ran cattle on the Alberthal farm and raised hay. Now that the property is ours, we still rent the pasture land out for cattle. The only elderly farmer still alive around here who remembers the Alberthal farm believes that the barn was built by one Siemus Riddle.

Please provide current photos of nominated property (interior and exterior (all four sides)) and a map indicating the location of property. Digital images are preferred (please provide disc) or print on photographic paper.

Only typed forms accepted. Please send an electronic copy of the completed form.

If you need assistance completing the form, please contact Michael Houser, State Architectural Historian, at 360-586-3076 or Michael.houser@dahp.wa.gov.

OTHER FARMSTEAD BUILDINGS

If building does not exist, please check N/A box

** Please provide additional digital photos of secondary buildings/structures*

	ROOF SHAPE	ROOF COVERING	FLOOR PLAN	SIDING	FOUNDATION MATERIAL	OTHER FEATURES: (Style, Color, Trim, etc..)	BUILT DATE
DWELLING <input type="checkbox"/> Good <input type="checkbox"/> Fair <input type="checkbox"/> Poor <input type="checkbox"/> Altered <input type="checkbox"/> Ruins <input type="checkbox"/> N/A	House collapsed						
OUTHOUSE <input type="checkbox"/> Good <input type="checkbox"/> Fair <input type="checkbox"/> Poor <input type="checkbox"/> Altered <input type="checkbox"/> Ruins <input type="checkbox"/> N/A							
CHICKEN COOP <input type="checkbox"/> Good <input type="checkbox"/> Fair <input type="checkbox"/> Poor <input type="checkbox"/> Altered <input type="checkbox"/> Ruins <input type="checkbox"/> N/A							
MACHINE SHED <input type="checkbox"/> Good <input type="checkbox"/> Fair <input type="checkbox"/> Poor <input type="checkbox"/> Altered <input type="checkbox"/> Ruins <input type="checkbox"/> N/A							
MILK HOUSE <input type="checkbox"/> Good <input type="checkbox"/> Fair <input type="checkbox"/> Poor <input type="checkbox"/> Altered <input type="checkbox"/> Ruins <input type="checkbox"/> N/A	Gable	Shakes covered with corrugated	rectangle	board & batten	rubble	used to be red	pre-1950
SILO <input type="checkbox"/> Good <input type="checkbox"/> Fair <input type="checkbox"/> Poor <input type="checkbox"/> Altered <input type="checkbox"/> Ruins <input type="checkbox"/> N/A							
OTHER: <input type="checkbox"/> Good <input type="checkbox"/> Fair <input type="checkbox"/> Poor <input type="checkbox"/> Altered <input type="checkbox"/> Ruins <input type="checkbox"/> N/A							
OTHER: Grainery <input type="checkbox"/> Good <input type="checkbox"/> Fair <input checked="" type="checkbox"/> Poor <input type="checkbox"/> Altered <input type="checkbox"/> Ruins <input type="checkbox"/> N/A							

Please provide a sketch of the farmstead layout indicating the location of other buildings in relation to the barn. Include an arrow pointing north for directional purposes.

Return form and additional documentation to: **DAHP** 1063 S. Capitol Way, Suite 106 Olympia, WA 98504

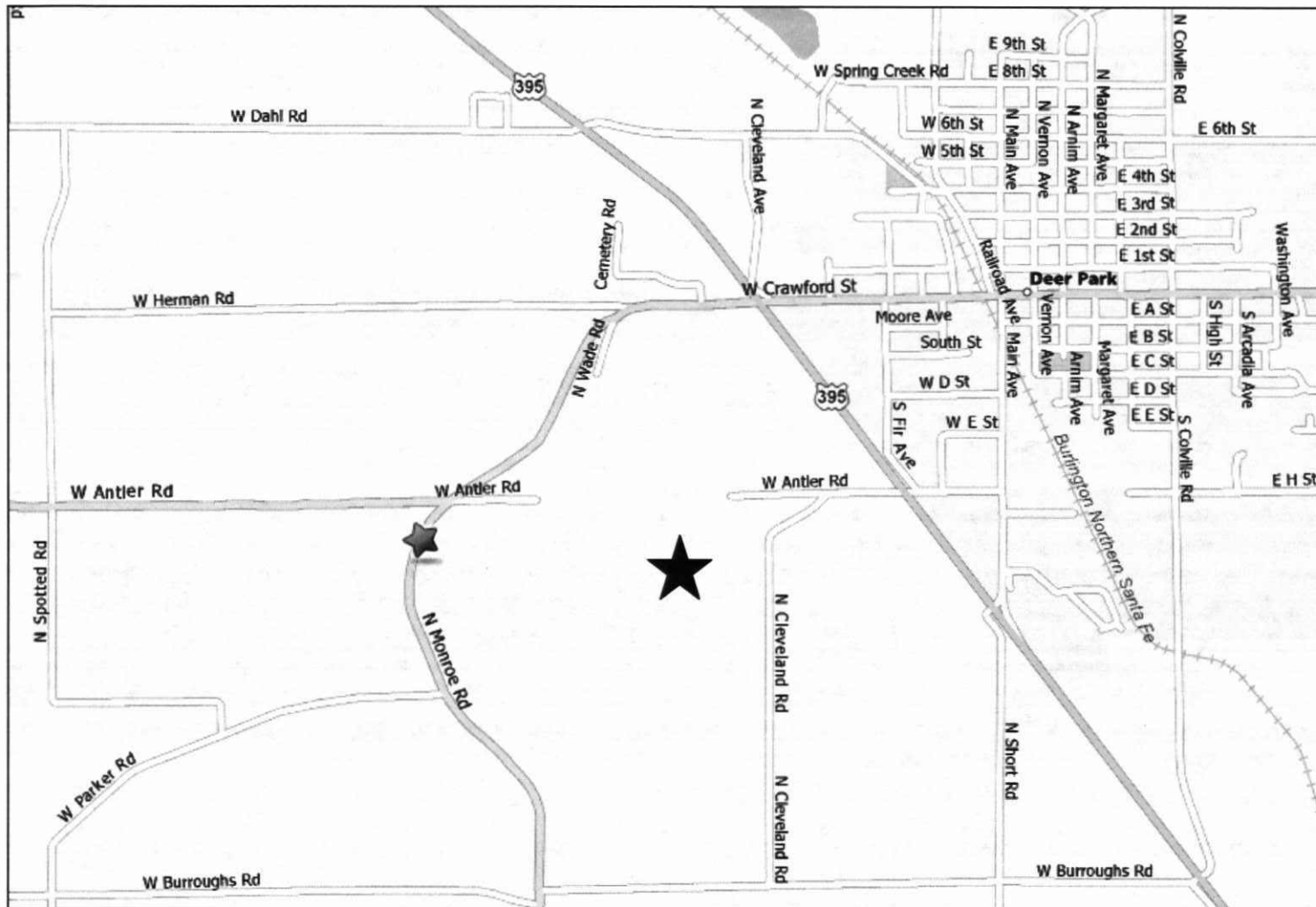

Alberthal Barn
31411 N. Monroe Road
Deer Park, WA 99006

PROPERTY OF
SPOKANE COUNTY
ASSESSOR

9 - 28 - 42

NE

NW

20 AC.



780'
904'
084'



TITLE

ADDRESS

SITE MAP

ALBERTHAL BARN
Neil & Mikie Gaber
6510 W. Burroughs Road
Deer Park WA 99006
509-276-2470

GABER

RD STRONG

1273.04

